

LEGEND:

- GENERAL TRACK WORKS
- EXISTING RAILWAY LINE TO BE ELECTRIFIED WITH OVERHEAD LINES
- EXISTING BRIDGE WORKS

NOTE:
PARAPET HEIGHTENING WORKS REQUIRED AT ALL BRIDGES FOR OVERHEAD LINE EQUIPMENT PROTECTION.

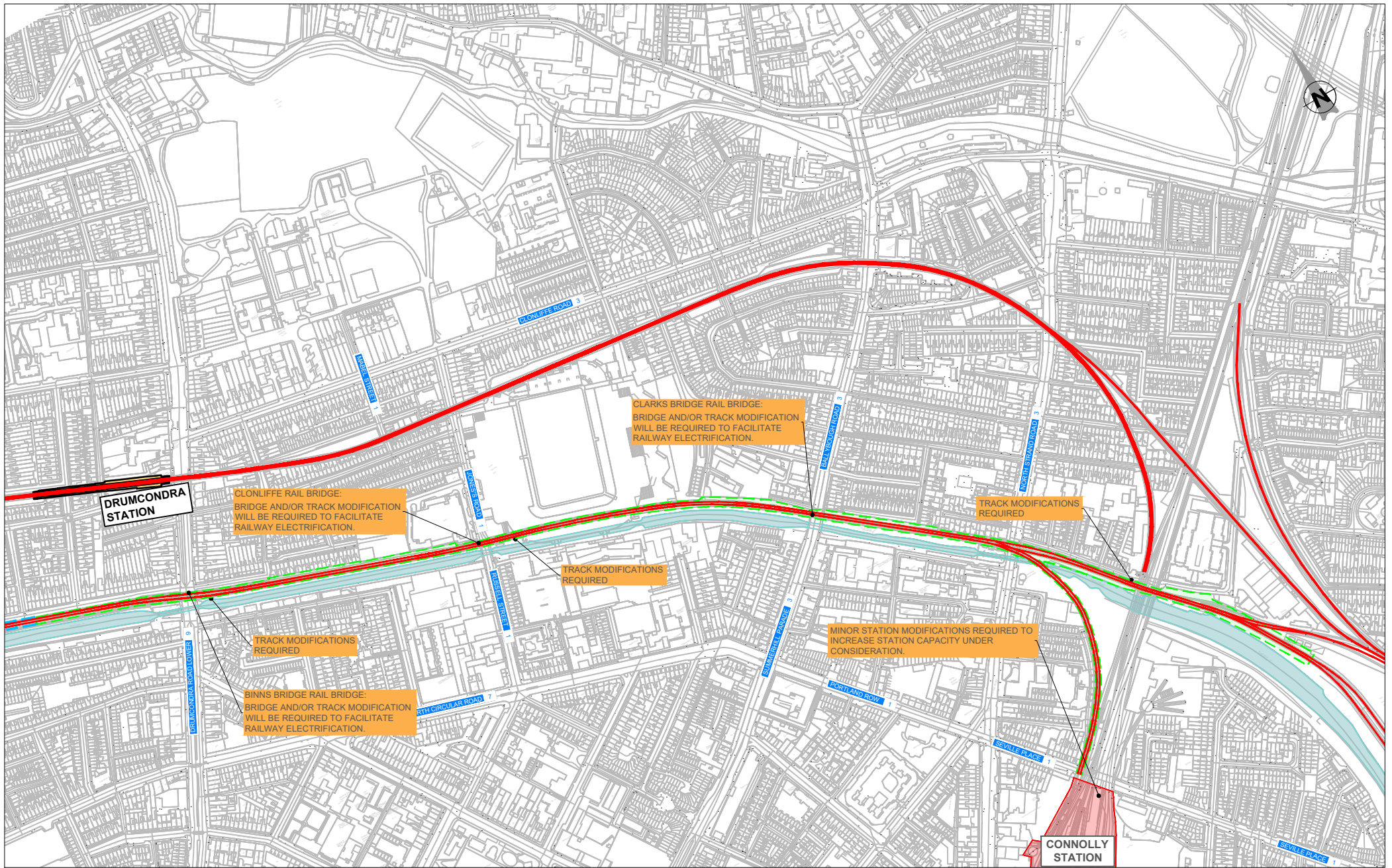

LEGEND:

- GENERAL TRACK WORKS
- EXISTING RAILWAY LINE TO BE ELECTRIFIED WITH OVERHEAD LINES
- EXISTING BRIDGE WORKS

NOTE:
PARAPET HEIGHTENING WORKS REQUIRED AT ALL BRIDGES FOR OVERHEAD LINE EQUIPMENT PROTECTION.

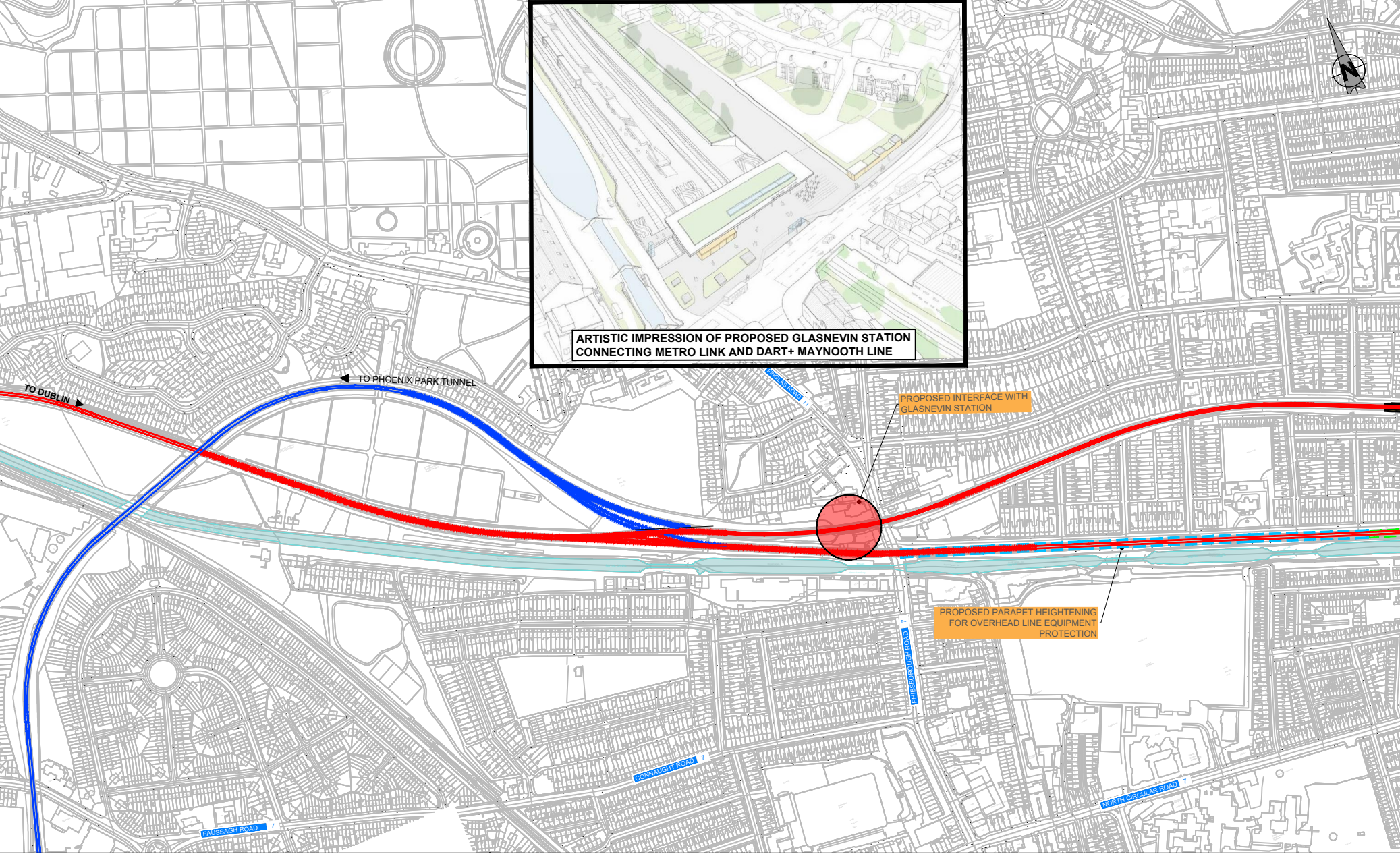

- LEGEND:**
- GENERAL TRACK WORKS
 - EXISTING RAILWAY LINE TO BE ELECTRIFIED WITH OVERHEAD LINES
 - EXISTING BRIDGE WORKS

NOTE:
PARAPET HEIGHTENING WORKS REQUIRED AT ALL BRIDGES FOR OVERHEAD LINE EQUIPMENT PROTECTION.

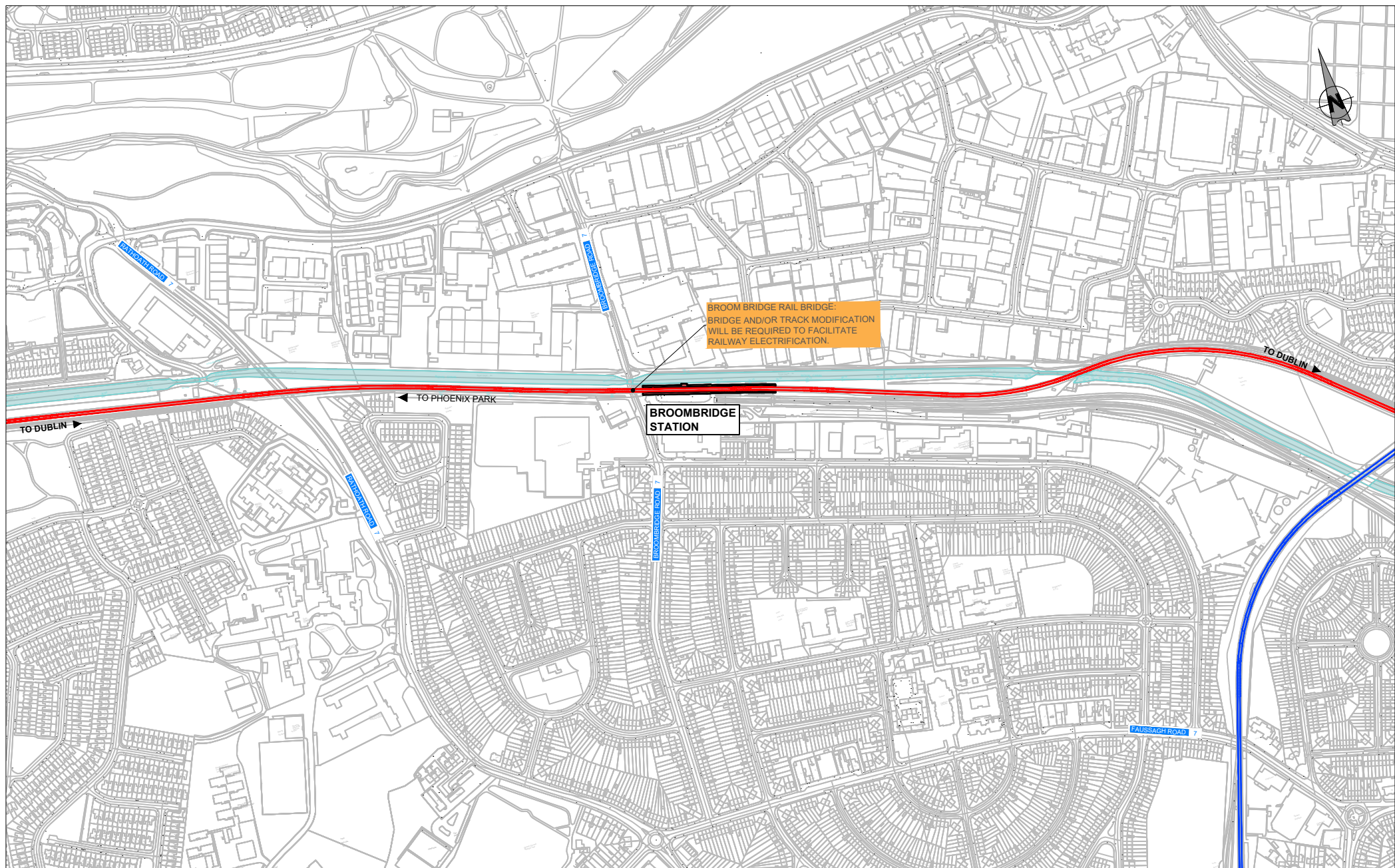

LEGEND:

- GENERAL TRACK WORKS
- EXISTING RAILWAY LINE TO BE ELECTRIFIED WITH OVERHEAD LINES
- EXISTING BRIDGE WORKS

NOTE:
PARAPET HEIGHTENING WORKS REQUIRED AT ALL BRIDGES FOR OVERHEAD LINE EQUIPMENT PROTECTION.

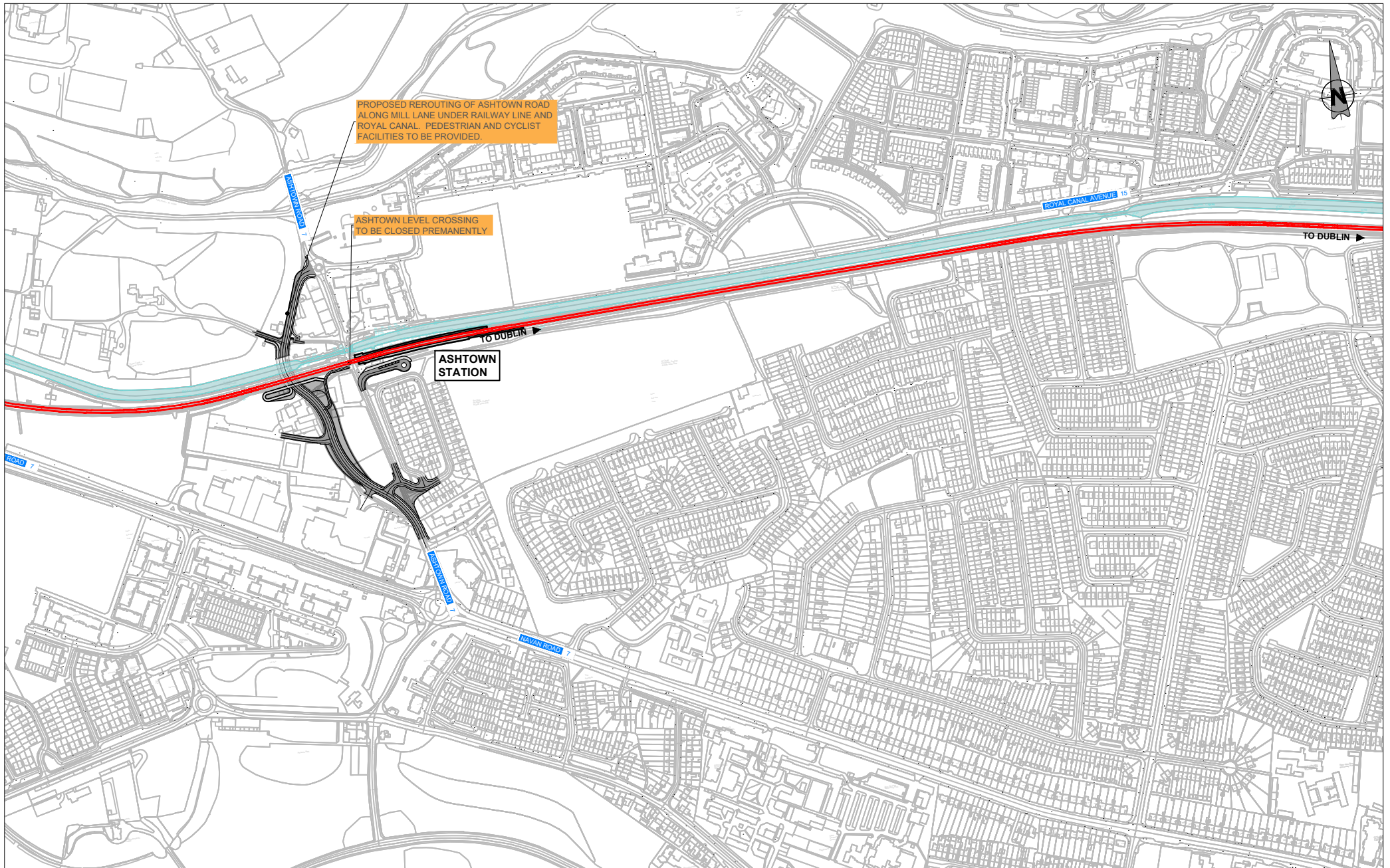

LEGEND:

- GENERAL TRACK WORKS
- EXISTING RAILWAY LINE TO BE ELECTRIFIED WITH OVERHEAD LINES
- EXISTING BRIDGE WORKS

NOTE:
PARAPET HEIGHTENING WORKS REQUIRED AT ALL BRIDGES FOR OVERHEAD LINE EQUIPMENT PROTECTION.

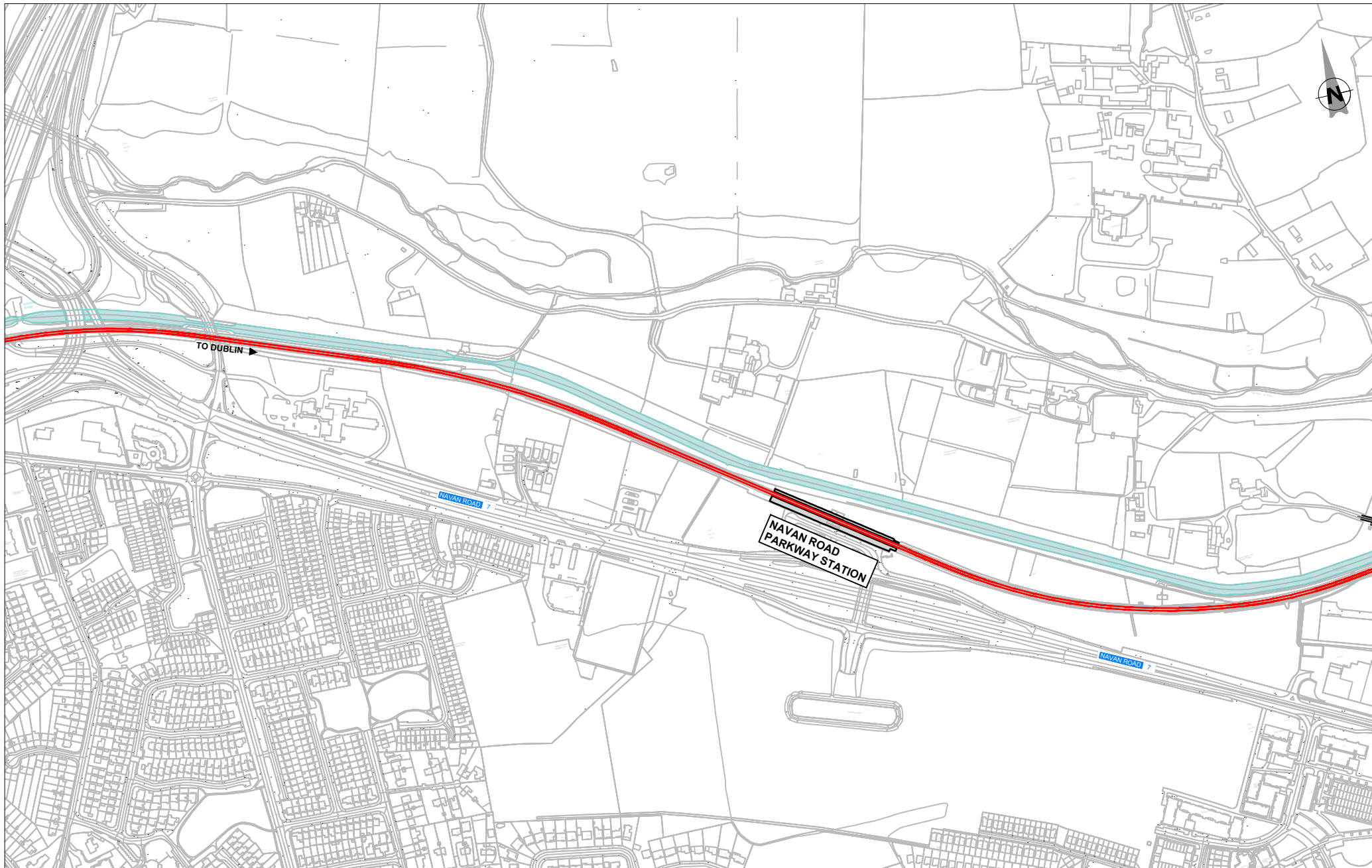

LEGEND:

- GENERAL TRACK WORKS
- EXISTING RAILWAY LINE TO BE ELECTRIFIED WITH OVERHEAD LINES
- EXISTING BRIDGE WORKS

NOTE:
PARAPET HEIGHTENING WORKS REQUIRED AT ALL BRIDGES FOR OVERHEAD LINE EQUIPMENT PROTECTION.

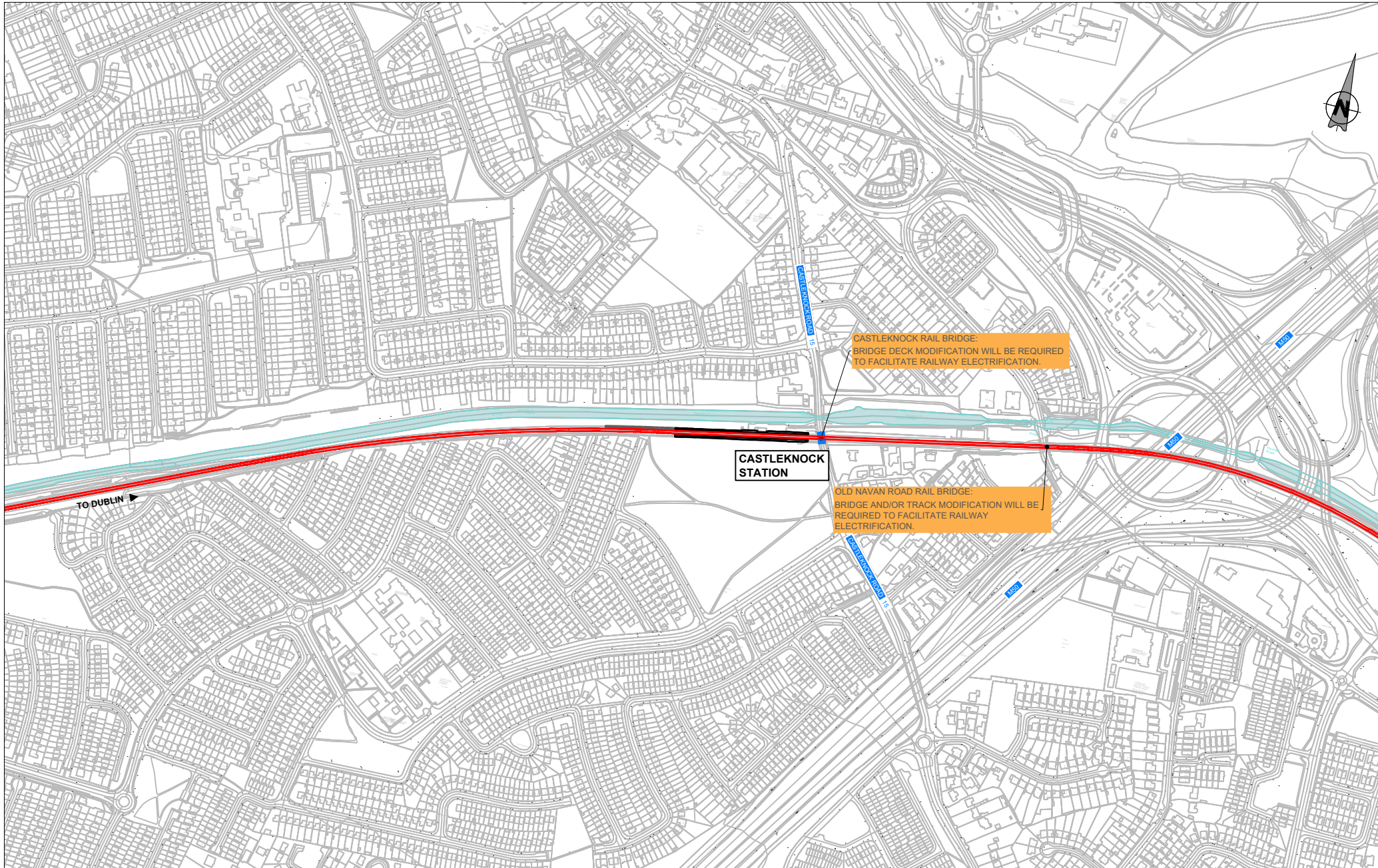

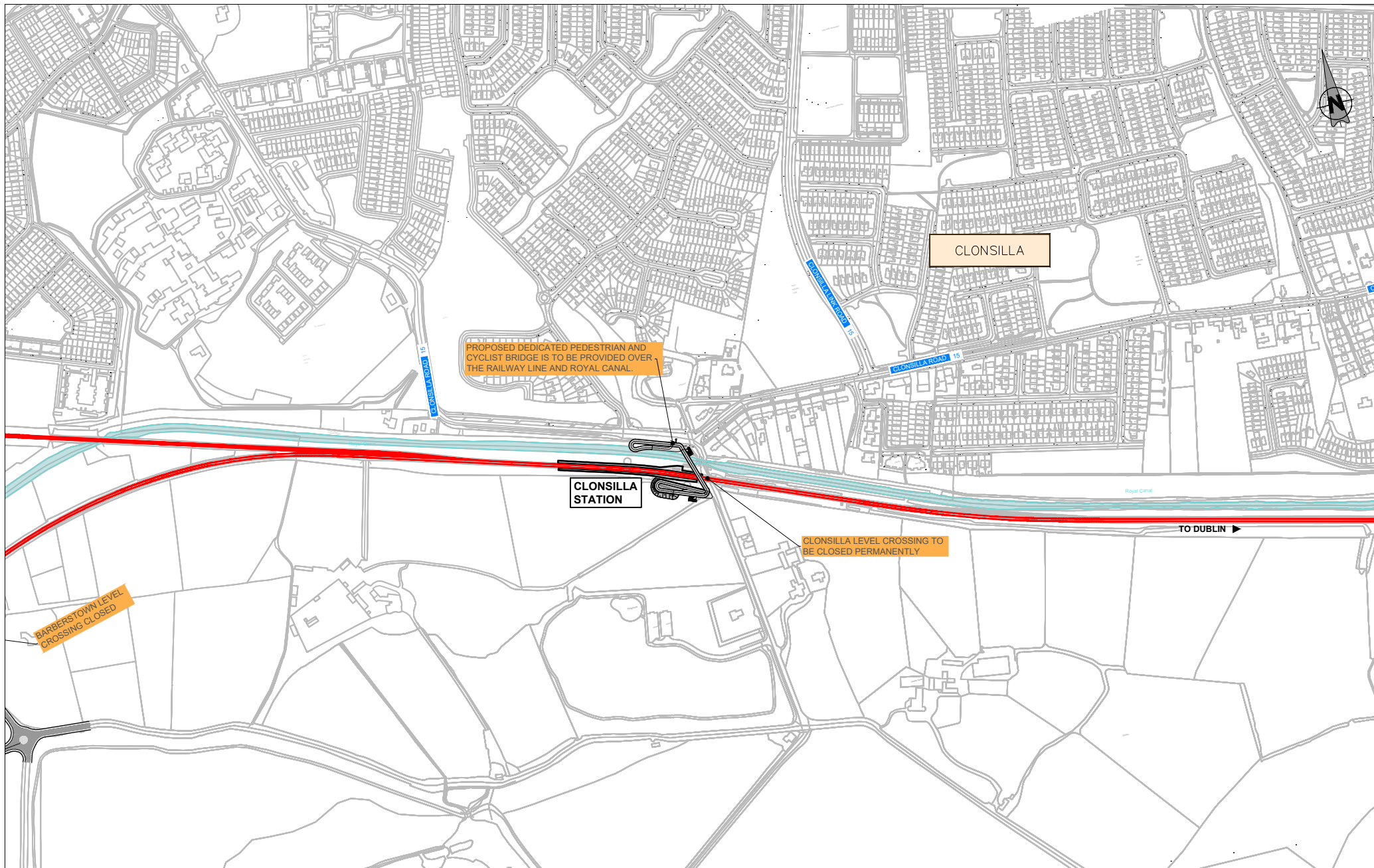

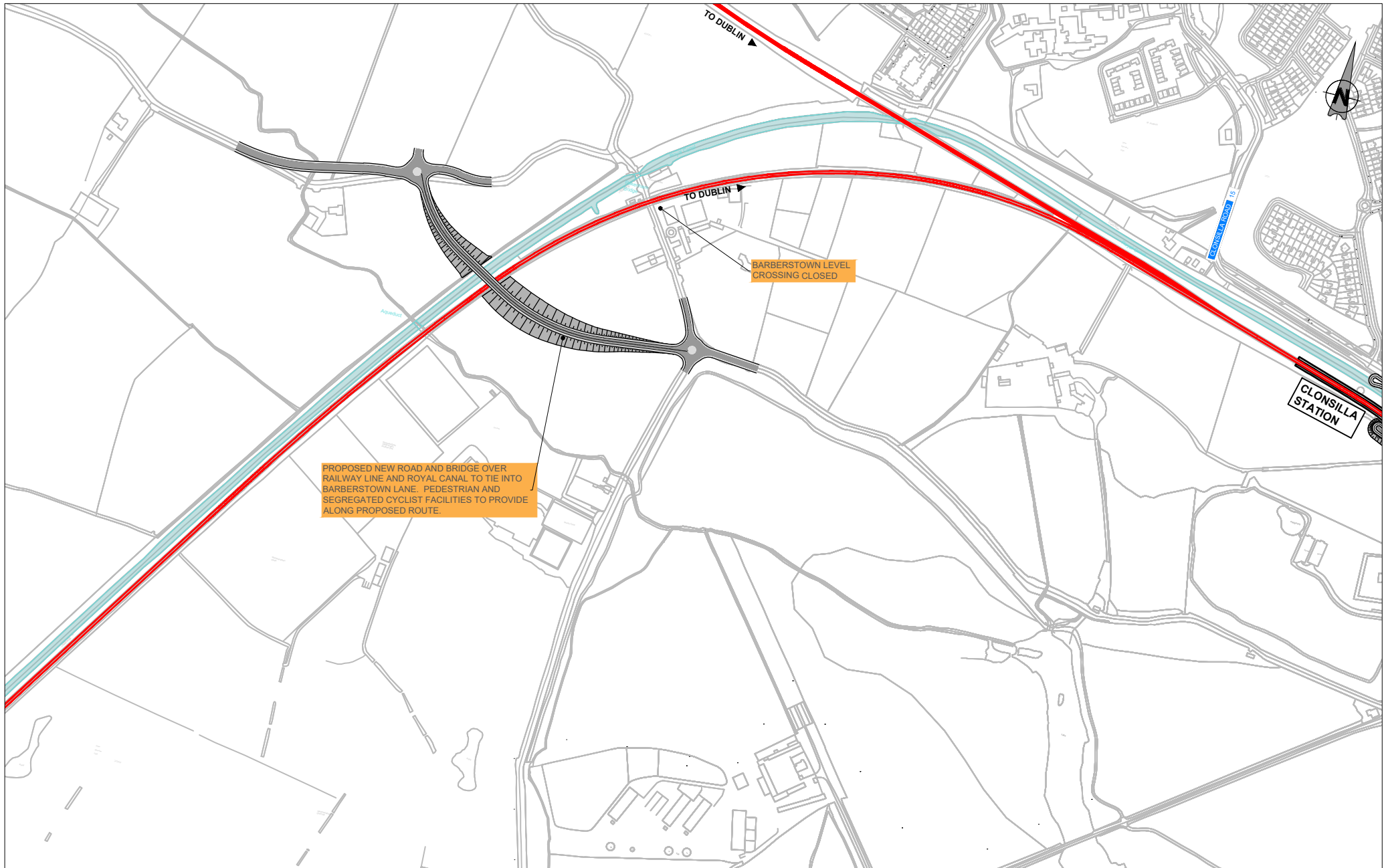

PROPOSED NEW ROAD AND BRIDGE OVER RAILWAY LINE AND ROYAL CANAL TO TIE INTO BARBERSTOWN LANE. PEDESTRIAN AND SEGREGATED CYCLIST FACILITIES TO PROVIDE ALONG PROPOSED ROUTE.

BARBERSTOWN LEVEL CROSSING CLOSED

CLONSILLA STATION

LEGEND:

- GENERAL TRACK WORKS
- EXISTING RAILWAY LINE TO BE ELECTRIFIED WITH OVERHEAD LINES
- EXISTING BRIDGE WORKS

NOTE:
PARAPET HEIGHTENING WORKS REQUIRED AT ALL BRIDGES FOR OVERHEAD LINE EQUIPMENT PROTECTION.

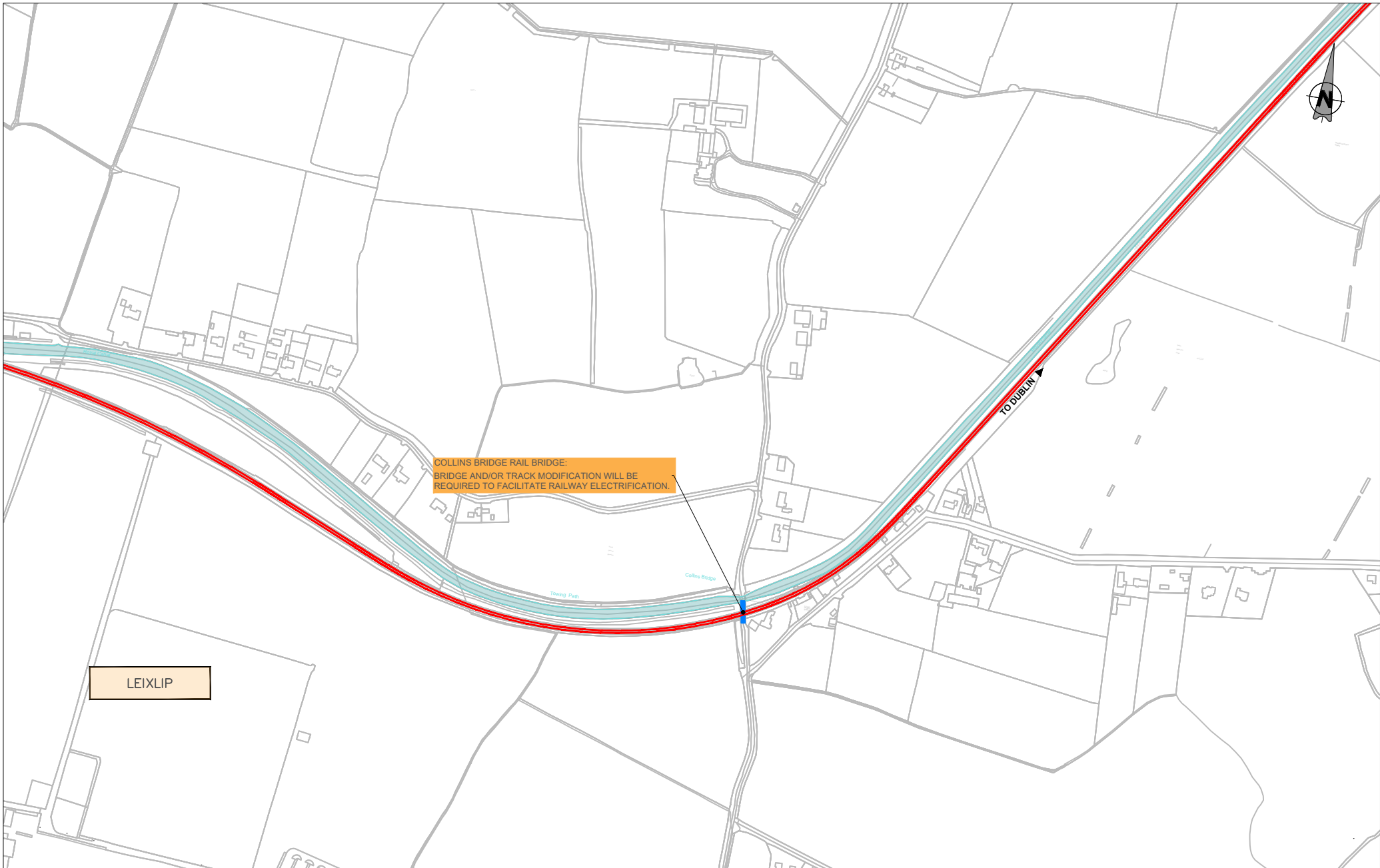

- LEGEND:**
- GENERAL TRACK WORKS
 - EXISTING RAILWAY LINE TO BE ELECTRIFIED WITH OVERHEAD LINES
 - EXISTING BRIDGE WORKS

NOTE:
 PARAPET HEIGHTENING WORKS REQUIRED AT ALL BRIDGES FOR OVERHEAD LINE EQUIPMENT PROTECTION.

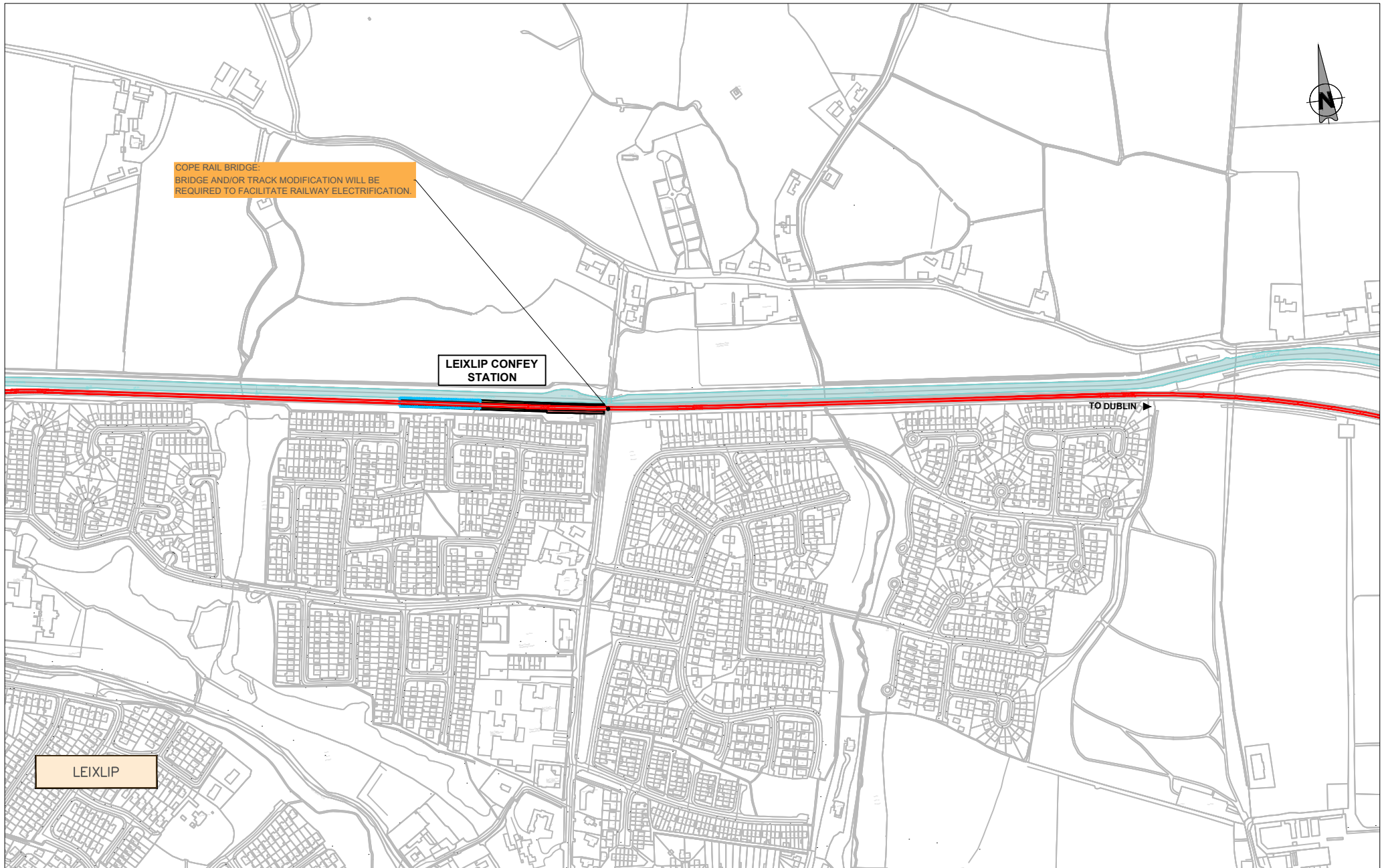

COPE RAIL BRIDGE:
BRIDGE AND/OR TRACK MODIFICATION WILL BE
REQUIRED TO FACILITATE RAILWAY ELECTRIFICATION.

LEIXLIP CONFHEY
STATION

TO DUBLIN ▶

LEIXLIP

LEGEND:

- GENERAL TRACK WORKS
- EXISTING RAILWAY LINE TO BE ELECTRIFIED WITH OVERHEAD LINES
- EXISTING BRIDGE WORKS

NOTE:
PARAPET HEIGHTENING WORKS REQUIRED AT ALL
BRIDGES FOR OVERHEAD LINE EQUIPMENT PROTECTION.

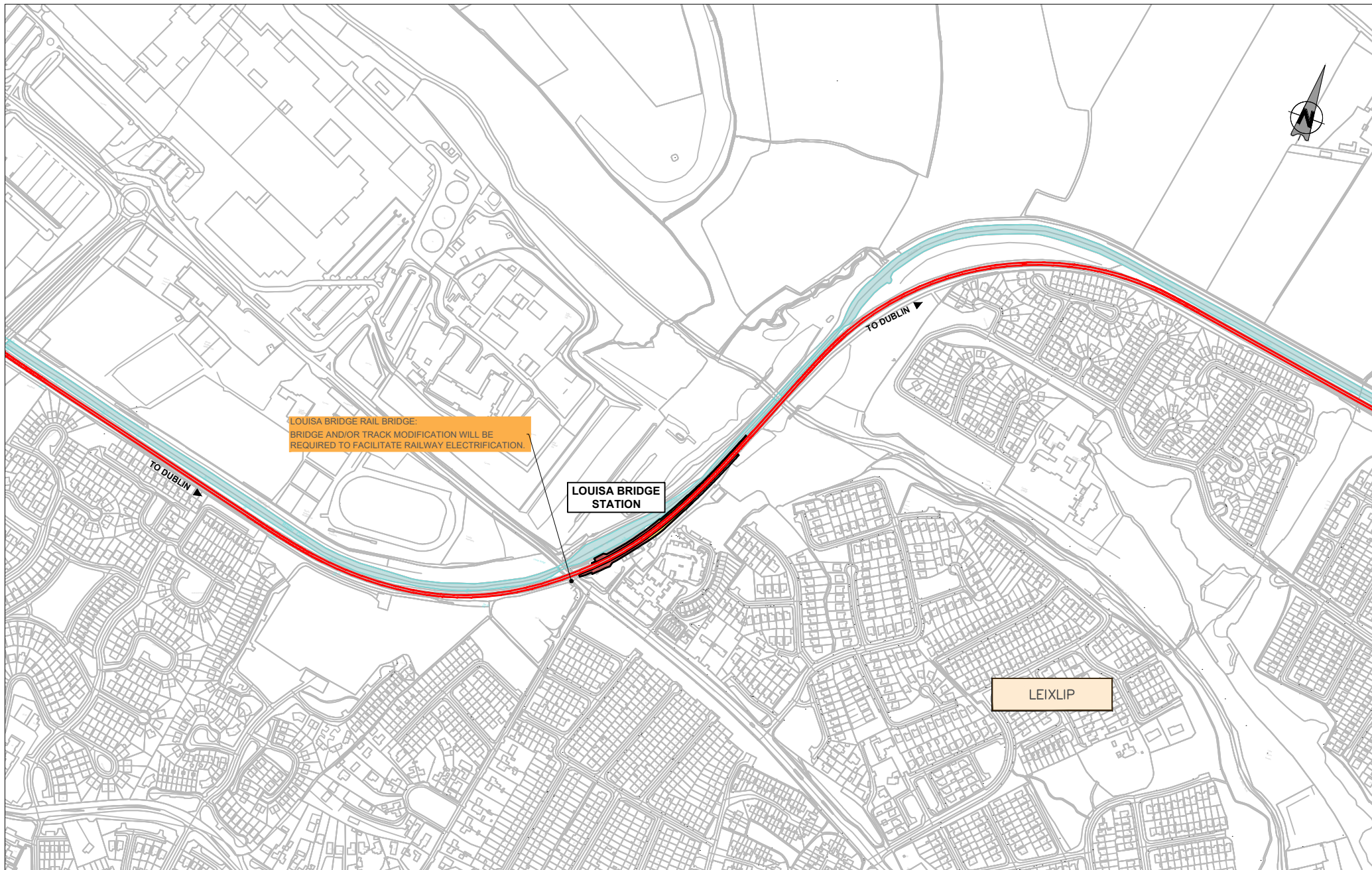

LEGEND:

- GENERAL TRACK WORKS
- EXISTING RAILWAY LINE TO BE ELECTRIFIED WITH OVERHEAD LINES
- EXISTING BRIDGE WORKS

NOTE:
PARAPET HEIGHTENING WORKS REQUIRED AT ALL
BRIDGES FOR OVERHEAD LINE EQUIPMENT PROTECTION.

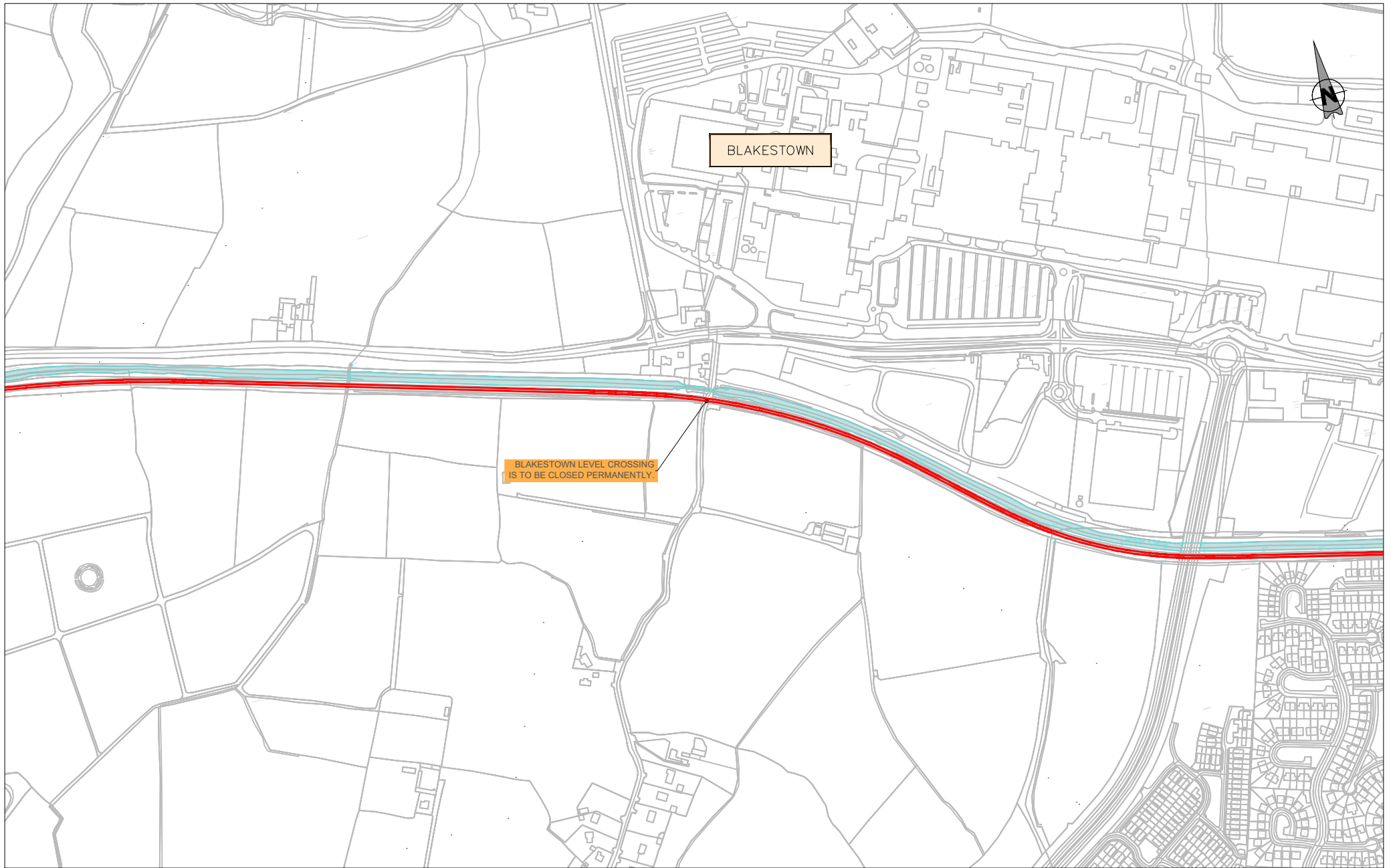

LEGEND:

- GENERAL TRACK WORKS
- EXISTING RAILWAY LINE TO BE ELECTRIFIED WITH OVERHEAD LINES
- EXISTING BRIDGE WORKS

NOTE:
PARAPET HEIGHTENING WORKS REQUIRED AT ALL BRIDGES FOR OVERHEAD LINE EQUIPMENT PROTECTION.

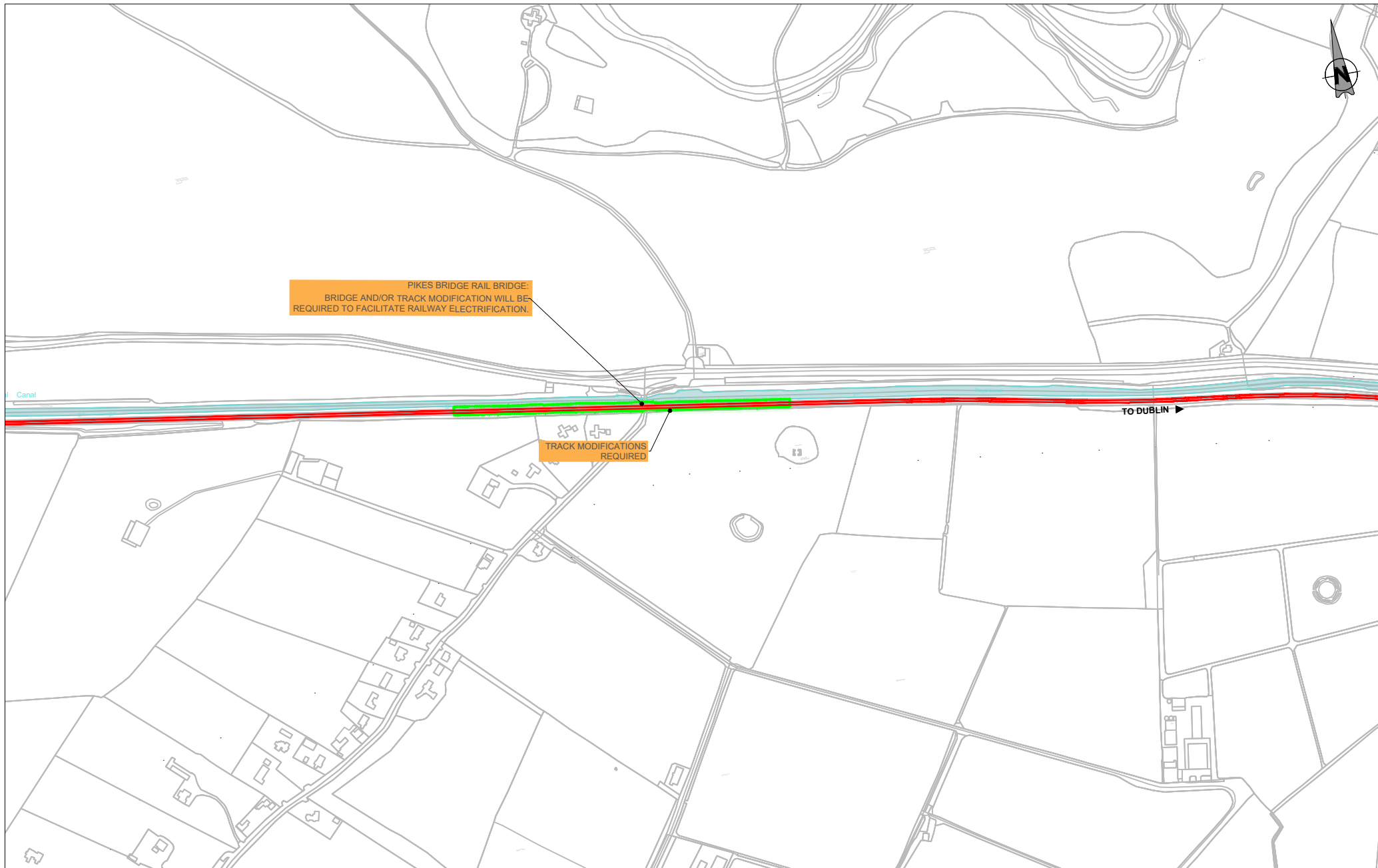

LEGEND:

- GENERAL TRACK WORKS
- EXISTING BRIDGE WORKS

- EXISTING RAILWAY LINE TO BE ELECTRIFIED WITH OVERHEAD LINES

NOTE:
PARAPET HEIGHTENING WORKS REQUIRED AT ALL BRIDGES FOR OVERHEAD LINE EQUIPMENT PROTECTION.

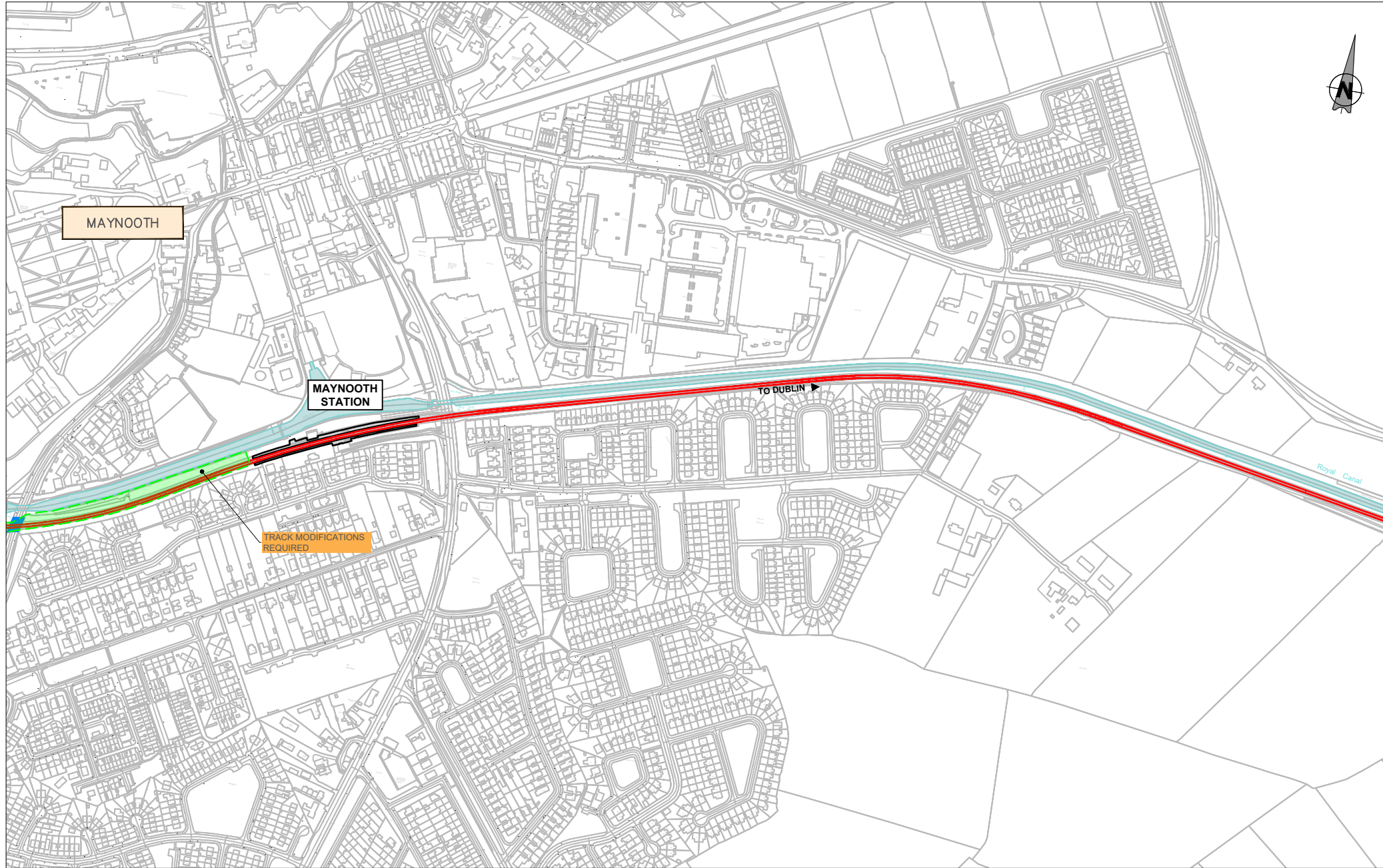

LEGEND:

- GENERAL TRACK WORKS
- EXISTING RAILWAY LINE TO BE ELECTRIFIED WITH OVERHEAD LINES
- EXISTING BRIDGE WORKS

NOTE:
PARAPET HEIGHTENING WORKS REQUIRED AT ALL BRIDGES FOR OVERHEAD LINE EQUIPMENT PROTECTION.

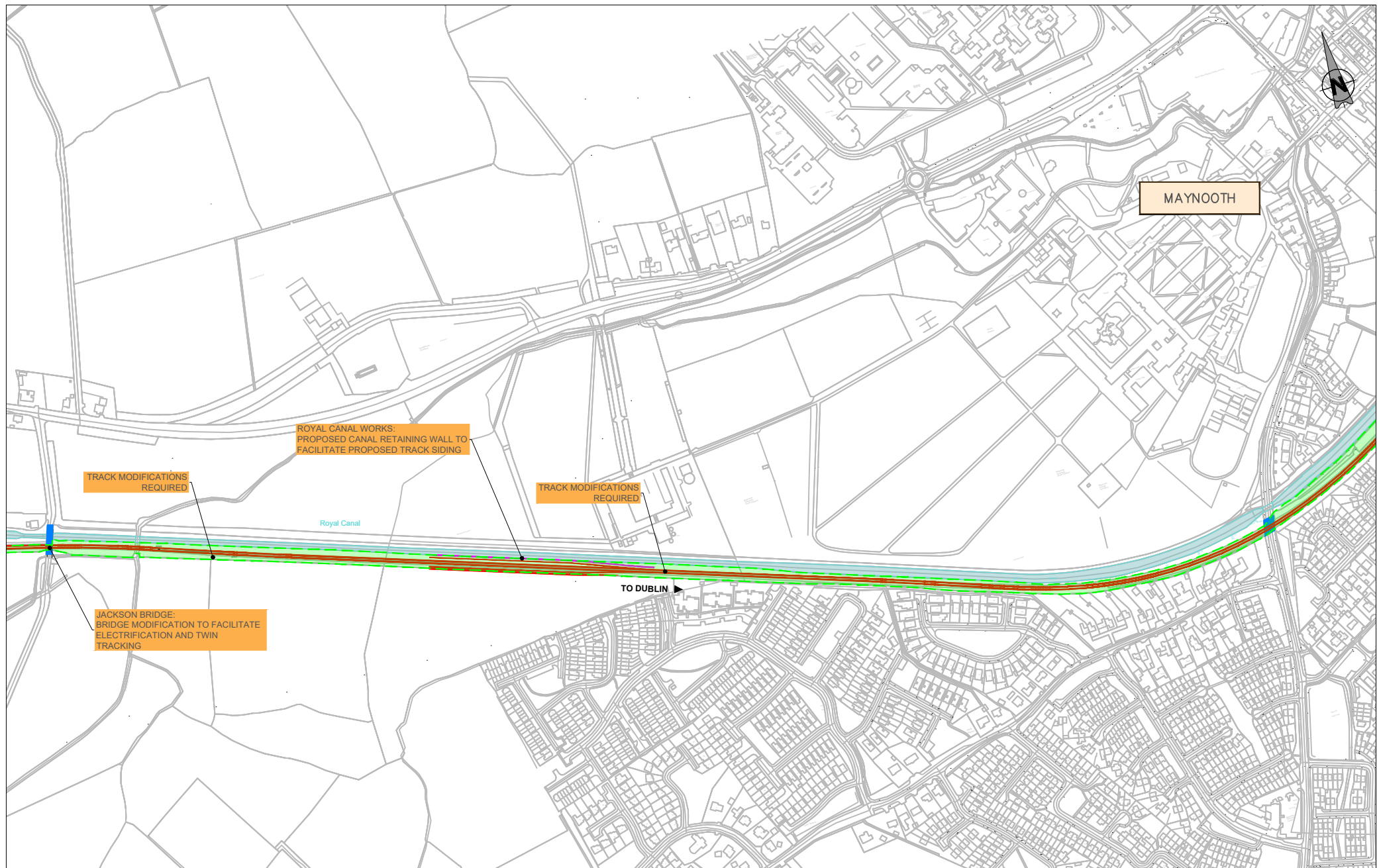

- LEGEND:**
- GENERAL TRACK WORKS
 - EXISTING RAILWAY LINE TO BE ELECTRIFIED WITH OVERHEAD LINES
 - EXISTING BRIDGE WORKS

NOTE:
PARAPET HEIGHTENING WORKS REQUIRED AT ALL BRIDGES FOR OVERHEAD LINE EQUIPMENT PROTECTION.

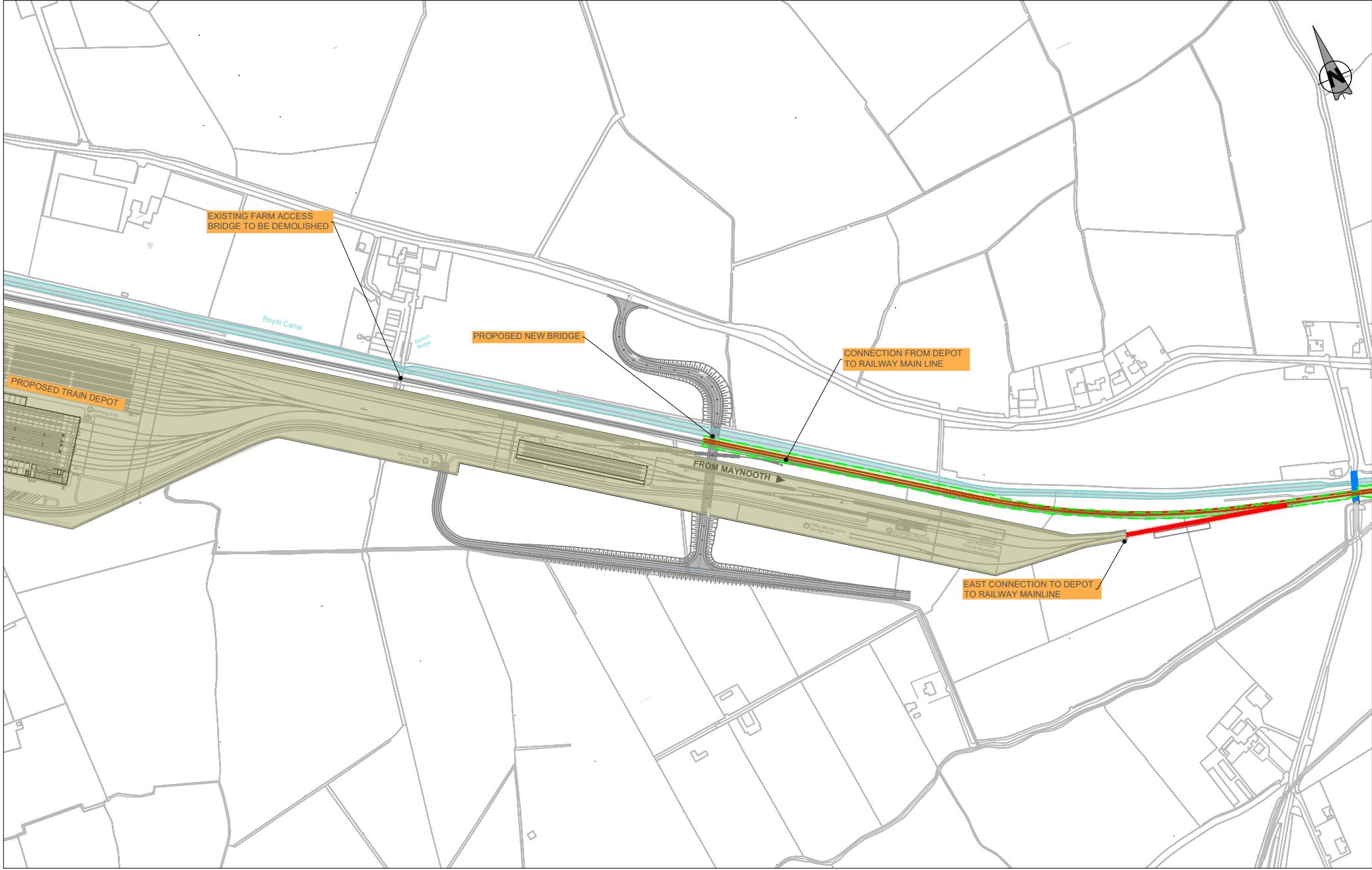

- LEGEND:**
- GENERAL TRACK WORKS
 - EXISTING RAILWAY LINE TO BE ELECTRIFIED WITH OVERHEAD LINES
 - EXISTING BRIDGE WORKS

NOTE:
 PARAPET HEIGHTENING WORKS REQUIRED AT ALL BRIDGES FOR OVERHEAD LINE EQUIPMENT PROTECTION.

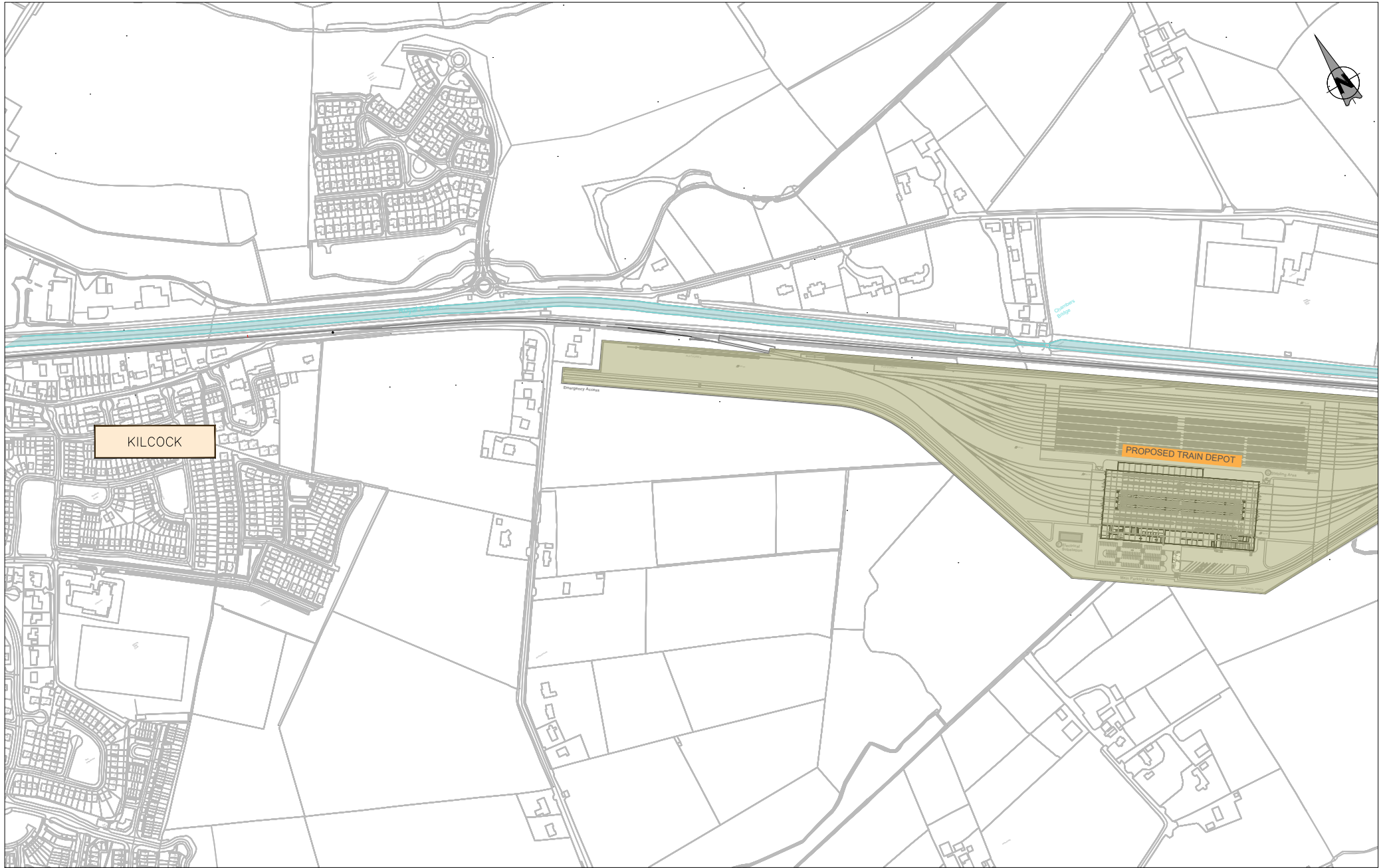

LEGEND:

- GENERAL TRACK WORKS
- EXISTING RAILWAY LINE TO BE ELECTRIFIED WITH OVERHEAD LINES
- EXISTING BRIDGE WORKS

NOTE:
PARAPET HEIGHTENING WORKS REQUIRED AT ALL BRIDGES FOR OVERHEAD LINE EQUIPMENT PROTECTION.

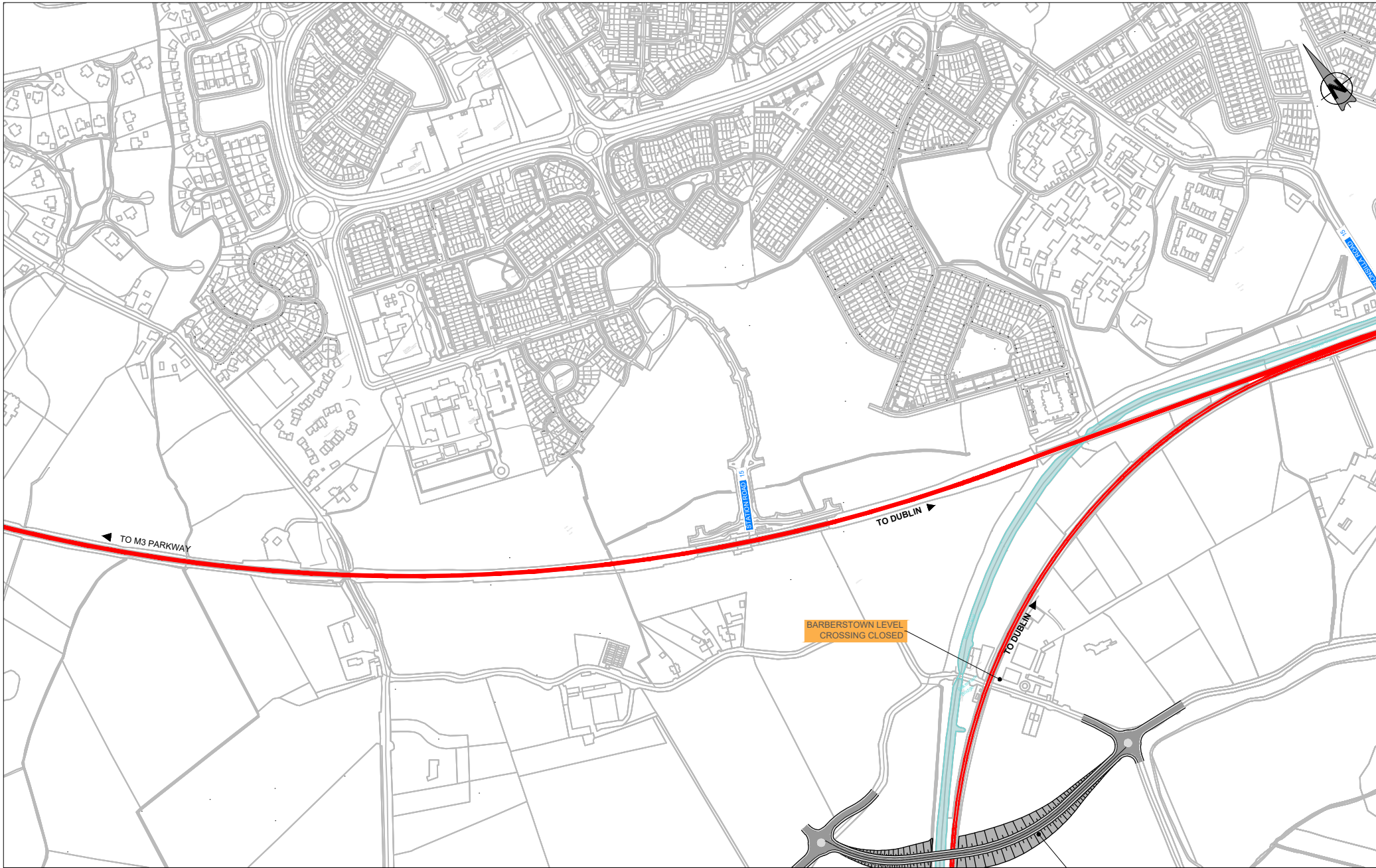

LEGEND:

- GENERAL TRACK WORKS
- EXISTING RAILWAY LINE TO BE ELECTRIFIED WITH OVERHEAD LINES
- EXISTING BRIDGE WORKS

NOTE:
PARAPET HEIGHTENING WORKS REQUIRED AT ALL BRIDGES FOR OVERHEAD LINE EQUIPMENT PROTECTION.

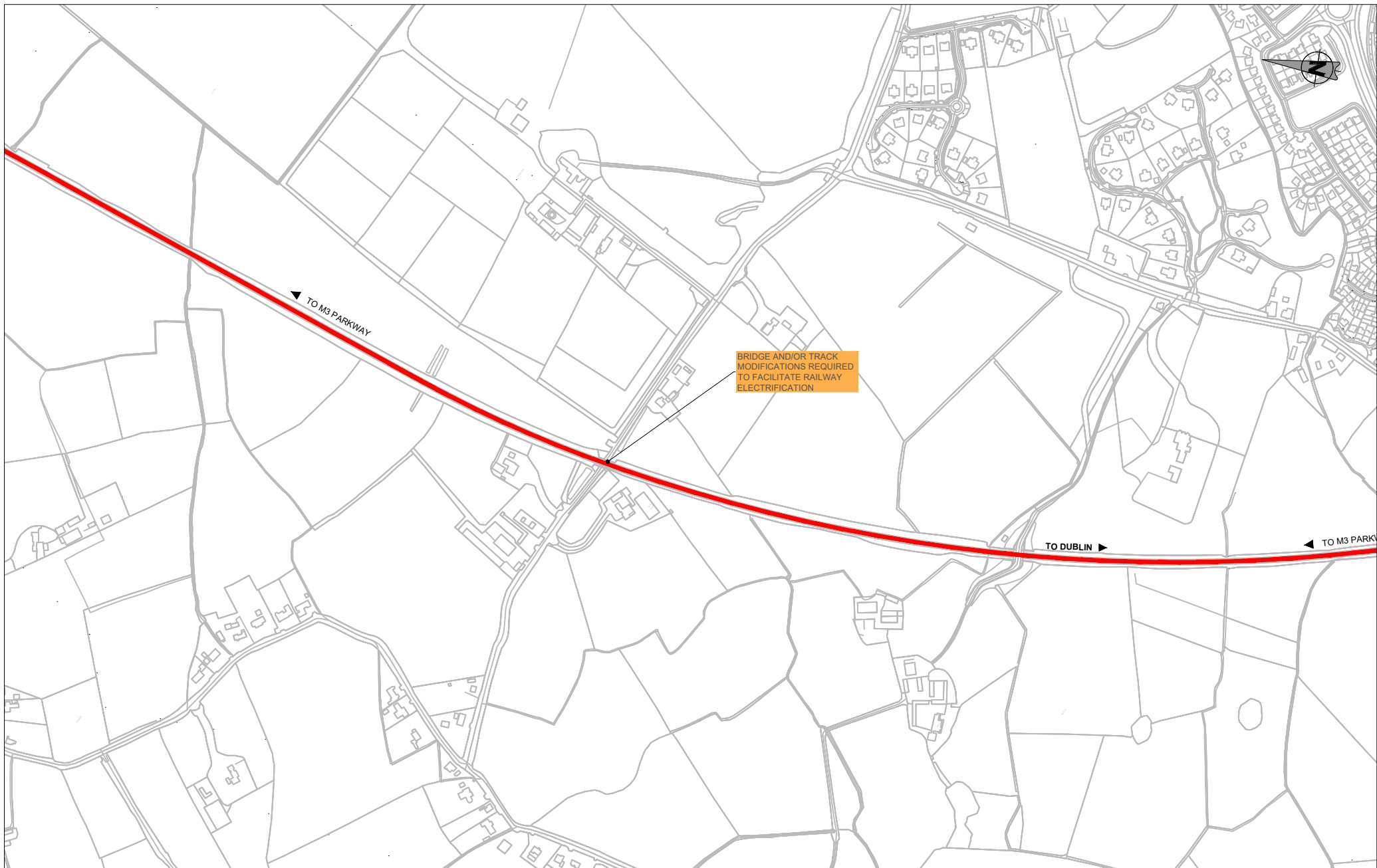

LEGEND:

- GENERAL TRACK WORKS
- EXISTING RAILWAY LINE TO BE ELECTRIFIED WITH OVERHEAD LINES
- EXISTING BRIDGE WORKS

NOTE:
PARAPET HEIGHTENING WORKS REQUIRED AT ALL BRIDGES FOR OVERHEAD LINE EQUIPMENT PROTECTION.

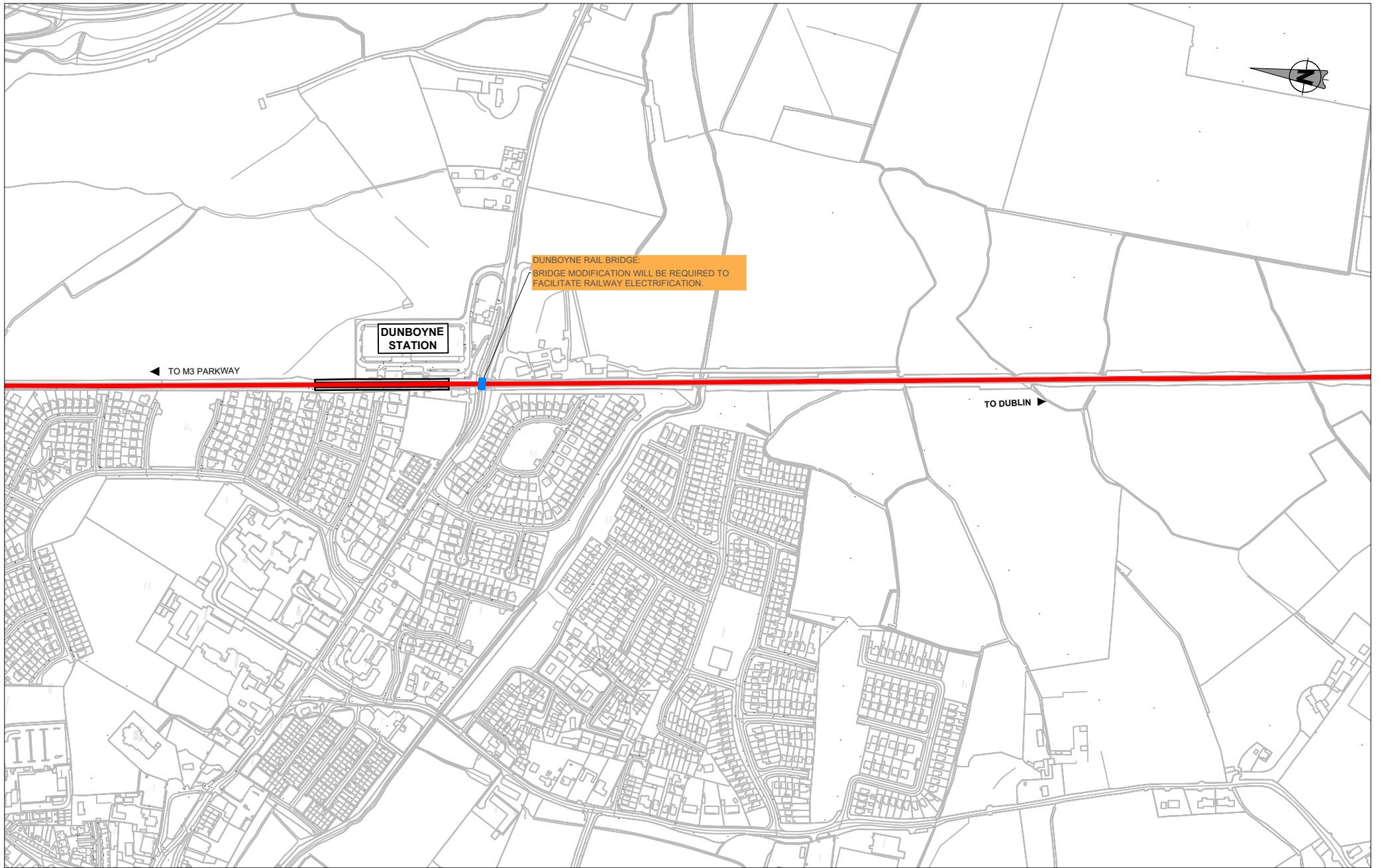



LEGEND:

- GENERAL TRACK WORKS
- EXISTING RAILWAY LINE TO BE ELECTRIFIED WITH OVERHEAD LINES
- EXISTING BRIDGE WORKS

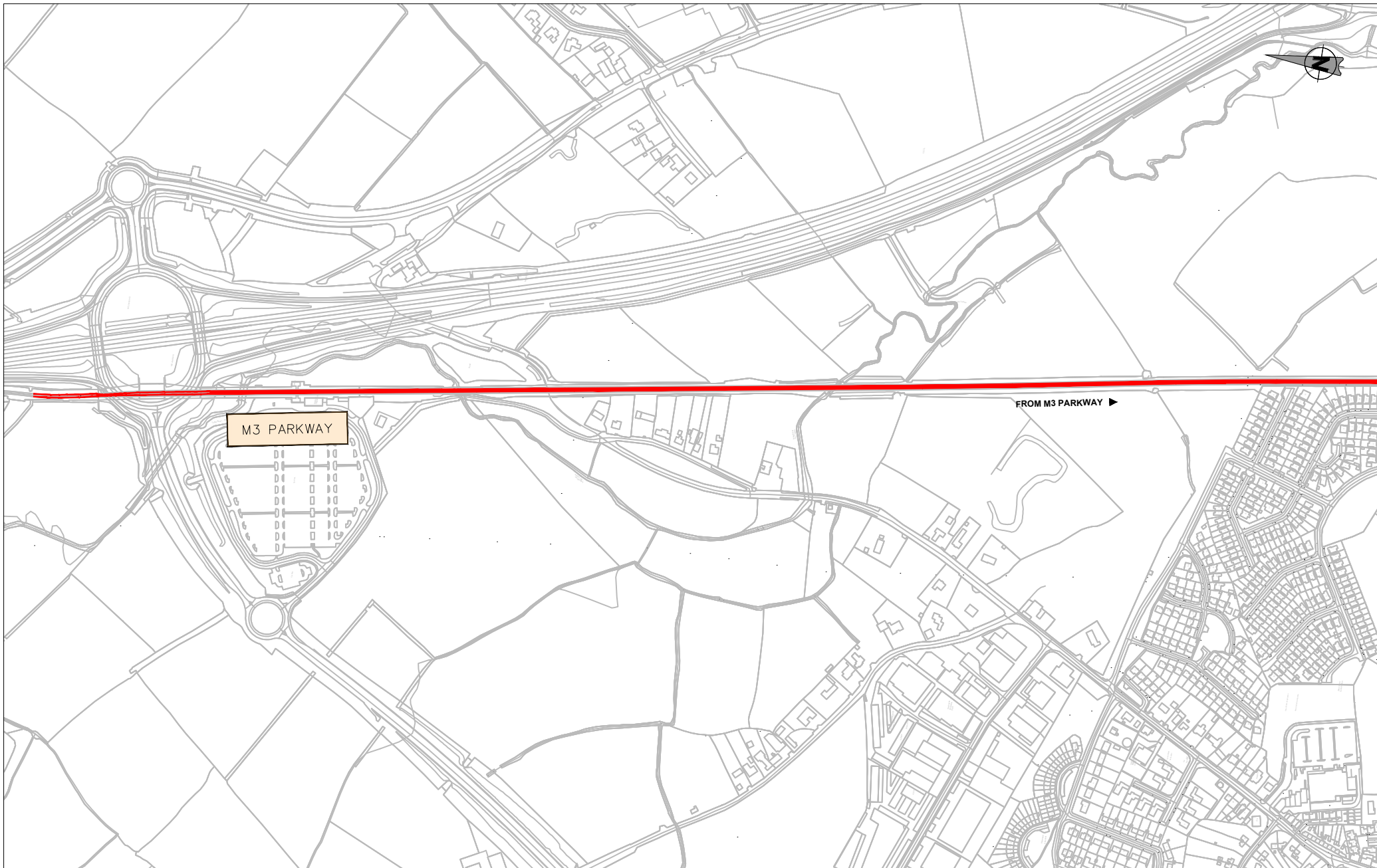
NOTE:
PARAPET HEIGHTENING WORKS REQUIRED AT ALL BRIDGES FOR OVERHEAD LINE EQUIPMENT PROTECTION.

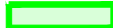

LEGEND:

-  GENERAL TRACK WORKS
-  EXISTING BRIDGE WORKS

 EXISTING RAILWAY LINE TO BE ELECTRIFIED WITH OVERHEAD LINES

NOTE:
PARAPET HEIGHTENING WORKS REQUIRED AT ALL BRIDGES FOR OVERHEAD LINE EQUIPMENT PROTECTION.