









- Legend:**
-  EXISTING HEDGEROW TO BE BOLSTERED (TYPE 1)
  -  PROPOSED HEDGEROW (TYPE 2)
  -  PROPOSED POST AND RAIL FENCE
  -  PROPOSED SHRUB MIX
  -  PROPOSED WILD GRASS SEEDING
  -  PROPOSED ADVANCED NURSERY STOCK
  -  PROPOSED SWALES
  -  SITE BOUNDARY

**Notes:**  
 The function of the proposed mitigation planting is primarily for screening, but it will also enhance the ecological corridors that area already present within the hedgerows.

**Hedgerows**  
 Mitigation screen planting shall consist of a mixture of native hedgerow species that are prevalent in the immediate area. Planting to consist of feathered whips (of various sizes) and advanced nursery stock (where necessary) in staggered rows at a spacing of 600mm.

'Under-planting' to consist of a single row of whips to the development side of existing tree lines and hedgerows. 'Inter-planting' to consist of a triple staggered row of whips and advanced nursery stock at 600mm spacing.

All native species will be planted as whips, with the primary and secondary structure species to be of a minimum height of 80-100cm and the other shrub species to be of a minimum height of 40-60cm.

Proposed hedgerows to be planted as per diagram LMP1.1 and LMP1.2, and maintained at a height of 3-4m unless otherwise specified.

**Low Shrub mix**  
 Low shrub species mix to comprise of Low-canopy: Sub-dominants (<10%), Understorey and Fringe: High-Shrubs (40-50%) and Understorey and Edge: Lower-Shrubs (40%-50%). Planting on embankments to be allowed to grow to reach maturity and to be concentrated on the lower portions of the embankments, as identified on the landscape plan.

**High-Shrubs** planted with spacing of between 900mm and 1500mm, while lower-shrubs are to be planted between 750mm and 900mm centres.

**Wild Grass Seeding**  
 Wild grass seeding of local provenance to be planted along the roadside verge.

Species mix to be finalised in conjunction with the project ecologist. All species to be from certified native stock and preferably from an approved supplier of the Green, Low-Carbon, Agri Environment Scheme (GLAS).

**NATIVE HEDGEROW SPECIES:**

Botanical name	Common name	Size	%
<i>Primary structure:</i>			
<i>Crataegus monogyna</i>	Hawthorn	1+2tr 80-100cm 10-12m girth 3m br standard trees	60%
<i>Secondary structure:</i>			
<i>Prunus spinosa</i>	Blackthorn	1+2tr 80-100cm	15%
<i>Ilex aquifolium</i>	Holly	1+2tr 80-100cm	15%
<i>Shrub species structure:</i>			
<i>Rubus fruticosus</i>	Bramble	1+1tr 40-60cm	2.5%
<i>Corylus avellana</i>	Hazel	1+1tr 40-60cm	2.5%
<i>Rosa canina</i>	Dog-rose	1+1tr 40-60cm	2.5%
<i>Euonymus europaeus</i>	Spindle	1+1tr 40-60cm	2.5%

**LOW SHRUB MIX:**

Botanical name	Common name	Size	%
<i>Low Canopy (Sub-dominants):</i>			
<i>Ainus glutinosa</i>	Alder	Feathered Trees 200-300cm 10-12m girth 3m br standard trees	<10%
<i>Betula pubescens</i>	Downy Birch	Feathered Trees 200-300cm 10-12m girth 3m br standard trees	
<i>Prunus avium</i>	Wild Cherry	1+1tr 80-100cm, bare root	
<i>Understorey and fringe (higher shrubs):</i>			
<i>Prunus Padus</i>	Bird Cherry	1+1tr 90-120cm	40-50%
<i>Corylus avellana</i>	Hazel	1+1tr 90-120cm	
<i>Ilex aquifolium</i>	Holly	1+1tr 90-120cm	
<i>Crataegus monogyna</i>	Hawthorn	1+1tr 90-120cm	
<i>Salix caprea</i>	Goat Willow	1+1tr 90-120cm	
<i>Understorey and edge (lower shrubs):</i>			
<i>Prunus spinosa</i>	Blackthorn	1+1tr 40-60cm	40-50%
<i>Rosa-canina</i>	Dog-rose	1+1tr 40-60cm	
<i>Euonymus europaeus</i>	Spindle	1+1tr 40-60cm	
<i>Salix aurita</i>	Eared Willow	1+1tr 40-60cm	
<i>Rubus fruticosus</i>	Bramble	1+1tr 40-60cm	

Prepared by:  
**MACRO WORKS,**  
 HIBERNIA HOUSE,  
 CHERRYWOOD BUSINESS PARK,  
 LOUGHLINSTOWN, DUBLIN 18  
 00363 (01) 2303585  
 info@macroworks.ie

Site location:  
**THOMASTOWN,  
 COUNTY CORK**

Drawing Title:  
**CORK LINE LEVEL CROSSINGS**

Project:  
**LANDSCAPE MITIGATION PLAN -  
 XC201 THOMASTOWN**

Drawn by:  
 CD

Checked by:  
 RB

Drawing Ref:  
**LD.CLLC.XC201**

Scale:  
 1:1250 @ A1

Date:  
 MARCH 2021

**ISSUED**

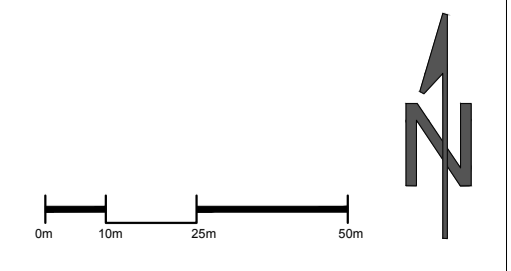
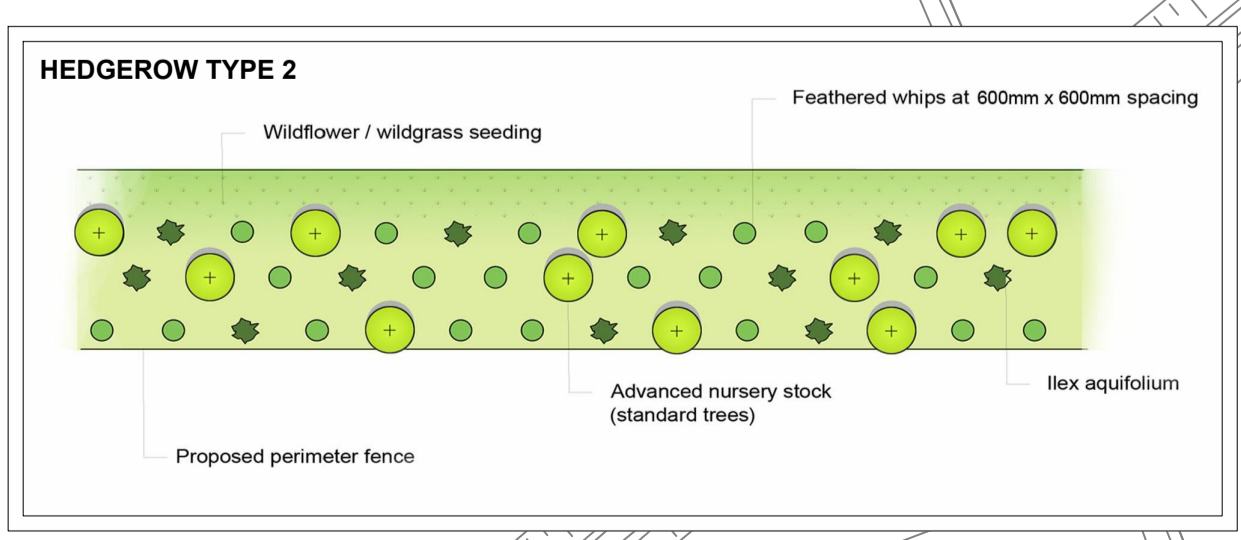
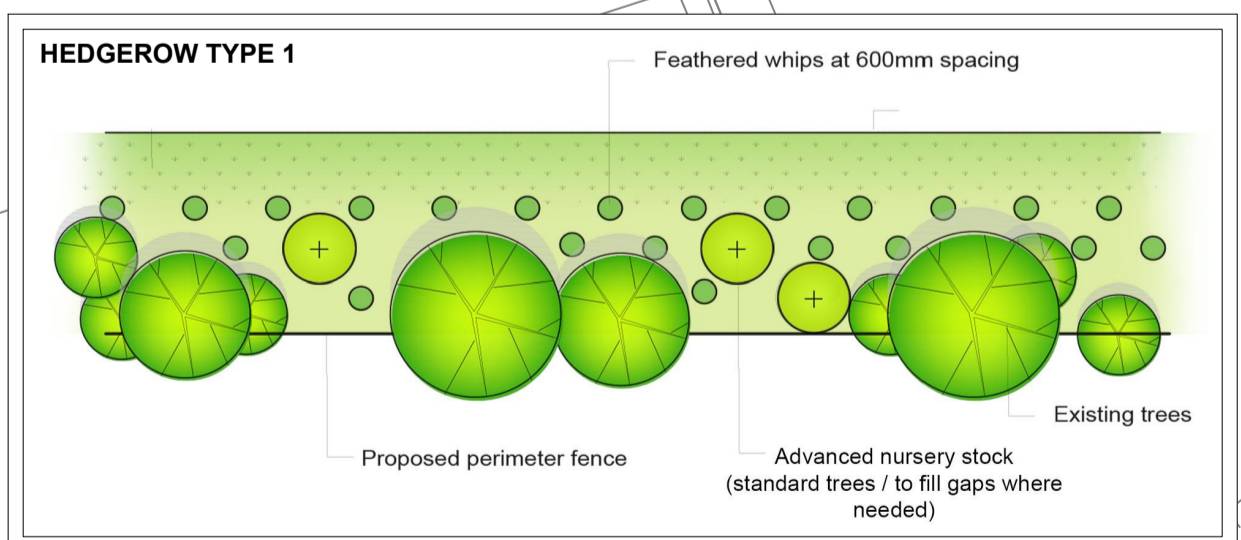



- Legend:**
- EXISTING HEDGEROW TO BE BOLSTERED (TYPE 1)
  - PROPOSED HEDGEROW (TYPE 2)
  - PROPOSED POST AND RAIL FENCE
  - PROPOSED WILD GRASS SEEDING
  - PROPOSED ADVANCED NURSERY STOCK
  - PROPOSED SWALES
  - SITE BOUNDARY

**Notes:**  
The function of the proposed mitigation planting is primarily for screening, but it will also enhance the ecological corridors that area already present within the hedgerows.

**Hedgerows**  
Mitigation screen planting shall consist of a mixture of native hedgerow species that are prevalent in the immediate area. Planting to consist of feathered whips (of various sizes) and advanced nursery stock (where necessary) in staggered rows at a spacing of 600mm.

'Under-planting' to consist of a single row of whips to the development side of existing tree lines and hedgerows. 'Inter-planting' to consist of a triple staggered row of whips and advanced nursery stock at 600mm spacing.

All native species will be planted as whips, with the primary and secondary structure species to be of a minimum height of 80-100cm and the other shrub species to be of a minimum height of 40-60cm.

Proposed hedgerows to be planted as per diagram LMP1.1 and LMP1.2, and maintained at a height of 3-4m unless otherwise specified.

**Wild Grass Seeding**  
Wild grass seeding of local provenance to be planted along the roadside verge.

Species mix to be finalised in conjunction with the project ecologist. All species to be from certified native stock and preferably from an approved supplier of the Green, Low-Carbon, Agri Environment Scheme (GLAS).

**NATIVE HEDGEROW SPECIES:**

Botanical name	Common name	Size	%
<i>Primary structure:</i>			
<i>Crataegus monogyna</i>	Hawthorn	1+2tr 80-100cm / 10-15m girth 3m or standard trees	60%
<i>Secondary structure:</i>			
<i>Prunus spinosa</i>	Blackthorn	1+2tr 80-100cm	15%
<i>Ilex aquifolium</i>	Holly	1+2tr 80-100cm	15%
<i>Shrub species structure:</i>			
<i>Rubus fruticosus</i>	Bramble	1+1tr 40-60cm	2.5%
<i>Corylus avellana</i>	Hazel	1+1tr 40-60cm	2.5%
<i>Rosa canina</i>	Dog-rose	1+1tr 40-60cm	2.5%
<i>Euonymus europaeus</i>	Spindle	1+1tr 40-60cm	2.5%

**LOW SHRUB MIX:**

Botanical name	Common name	Size	%	
<i>Low Canopy (Sub-dominant):</i>				
<i>Alnus glutinosa</i>	Alder	Feathered Trees 200-300cm	<10%	
<i>Betula pubescens</i>	Downy Birch	Feathered Trees 200-300cm		
<i>Prunus avium</i>	Wild Cherry	1+1tr 60-100cm, bare root		
<i>Understorey and fringe (higher shrubs):</i>				
<i>Prunus Padus</i>	Bird Cherry	1+1tr 90-120cm	40-50%	
<i>Corylus avellana</i>	Hazel	1+1tr 90-120cm		
<i>Ilex aquifolium</i>	Holly	1+1tr 90-120cm		
<i>Crataegus monogyna</i>	Hawthorn	1+1tr 90-120cm		
<i>Salix caprea</i>	Goat Willow	1+1tr 90-120cm		
<i>Salix purpurea</i>	Purple Willow	1+1tr 90-120cm	40-50%	
<i>Understorey and edge (lower shrubs):</i>				
<i>Prunus spinosa</i>	Blackthorn	1+1tr 40-60cm		
<i>Rosa-canina</i>	Dog-rose	1+1tr 40-60cm		
<i>Euonymus europaeus</i>	Spindle	1+1tr 40-60cm		
<i>Salix aurita</i>	Eared Willow	1+1tr 40-60cm		
<i>Rubus fruticosus</i>	Bramble	1+1tr 40-60cm		

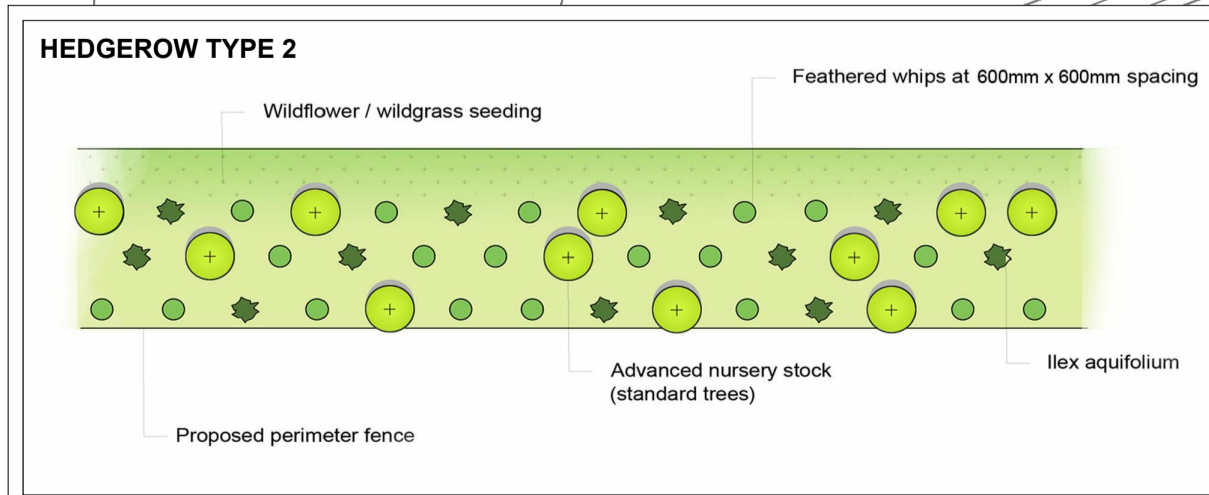
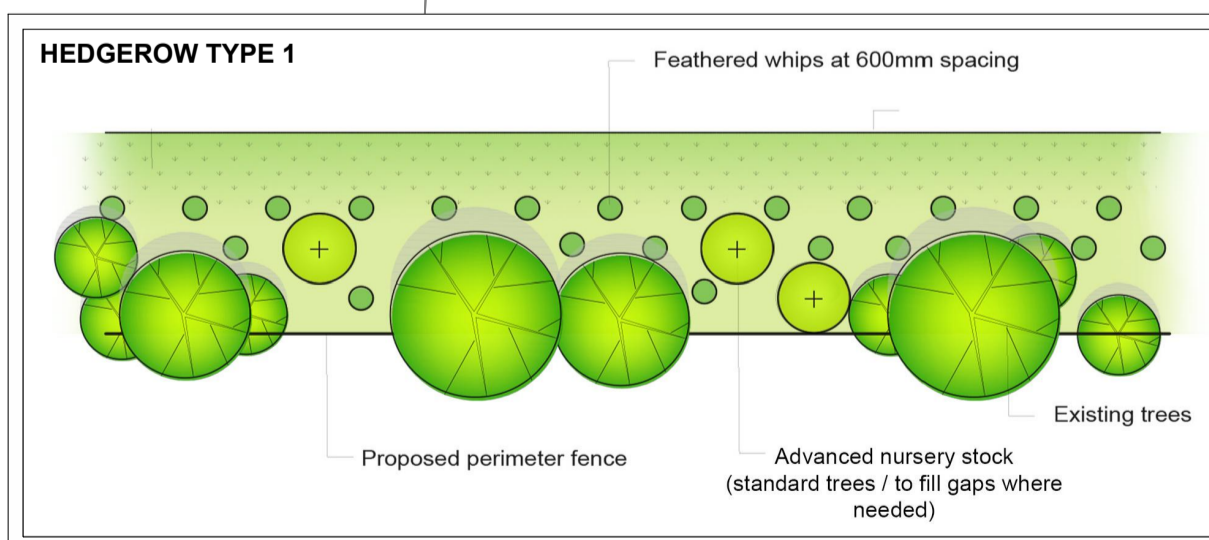

Prepared by:  
**MACRO WORKS,**  
HIBERNIA HOUSE,  
CHERRYWOOD BUSINESS PARK,  
LOUGHLINSTOWN, DUBLIN 18  
00353 (01) 2305585  
info@macroworks.ie

Site location:  
**NEWTOWN,  
COUNTY CORK**

Drawing Title:  
**CORK LINE LEVEL CROSSINGS**

Project:  
**LANDSCAPE MITIGATION PLAN -  
XC211 NEWTOWN**

Drawn by: CD Checked by: RB

Drawing Ref: **LD.CLLC.XC211**

Scale: 1:1000 @ A1 Date: MARCH 2021

**ISSUED**

- Legend:**
- EXISTING HEDGEROW TO BE BOLSTERED (TYPE 1)
  - PROPOSED HEDGEROW (TYPE 2)
  - PROPOSED POST AND RAIL FENCE
  - PROPOSED SHRUB MIX
  - PROPOSED WILD GRASS SEEDING
  - PROPOSED ADVANCED NURSERY STOCK
  - PROPOSED SWALES
  - SITE BOUNDARY

**Notes:**

The function of the proposed mitigation planting is primarily for screening, but it will also enhance the ecological corridors that area already present within the hedgerows.

**Hedgerows**  
Mitigation screen planting shall consist of a mixture of native hedgerow species that are prevalent in the immediate area. Planting to consist of feathered whips (of various sizes) and advanced nursery stock (where necessary) in staggered rows at a spacing of 600mm.

'Under-planting' to consist of a single row of whips to the development side of existing tree lines and hedgerows. 'Inter-planting' to consist of a triple staggered row of whips and advanced nursery stock at 600mm spacing.

All native species will be planted as whips, with the primary and secondary structure species to be of a minimum height of 80-100cm and the other shrub species to be of a minimum height of 40-60cm.

Proposed hedgerows to be planted as per diagram LMP1.1 and LMP1.2, and maintained at a height of 3-4m unless otherwise specified.

**Low Shrub mix**  
Low shrub species mix to comprise of Low-canopy: Sub-dominants (<10%), Understorey and Fringe: High-Shrubs (40-50%) and Understorey and Edge: Lower-Shrubs (40%-50%). Planting on embankments to be allowed to grow to reach maturity and to be concentrated on the lower portions of the embankments, as identified on the landscape plan.

High-Shrubs planted with spacing of between 900mm and 1500mm, while lower-shrubs are to be planted between 750mm and 900mm centres.

**Wild Grass Seeding**  
Wild grass seeding of local provenance to be planted along the roadside verge.

Species mix to be finalised in conjunction with the project ecologist. All species to be from certified native stock and preferably from an approved supplier of the Green, Low-Carbon, Agri Environment Scheme (GLAS).

**NATIVE HEDGEROW SPECIES:**

Botanical name	Common name	Size	%
<i>Primary structure:</i>			
<i>Crataegus monogyna</i>	Hawthorn	1+2tr 80-100cm 10-12cm girth, 3m or standard trees	60%
<i>Secondary structure:</i>			
<i>Prunus spinosa</i>	Blackthorn	1+2tr 80-100cm	15%
<i>Ilex aquifolium</i>	Holly	1+2tr 80-100cm	15%
<i>Shrub species structure:</i>			
<i>Rubus fruticosus</i>	Bramble	1+1tr 40-60cm	2.5%
<i>Corylus avellana</i>	Hazel	1+1tr 40-60cm	2.5%
<i>Rosa canina</i>	Dog-rose	1+1tr 40-60cm	2.5%
<i>Euonymus europaeus</i>	Spindle	1+1tr 40-60cm	2.5%

**LOW SHRUB MIX:**

Botanical name	Common name	Size	%
<i>Low Canopy (Sub-dominants):</i>			
<i>Ainus glutinosa</i>	Alder	Feathered Trees 200-300cm 10-12cm girth, 3m or standard trees	<10%
<i>Betula pubescens</i>	Downy Birch	Feathered Trees 200-300cm 10-12cm girth, 3m or standard trees	
<i>Prunus avium</i>	Wild Cherry	1+1tr 40-60cm, bare root	
<i>Understorey and fringe (higher shrubs):</i>			
<i>Prunus Padus</i>	Bird Cherry	1+1tr 90-120cm	40-50%
<i>Corylus avellana</i>	Hazel	1+1tr 90-120cm	
<i>Ilex aquifolium</i>	Holly	1+1tr 90-120cm	
<i>Crataegus monogyna</i>	Hawthorn	1+1tr 90-120cm	40-50%
<i>Salix caprea</i>	Goat Willow	1+1tr 90-120cm	
<i>Salix purpurea</i>	Purple Willow	1+1tr 90-120cm	
<i>Understorey and edge (lower shrubs):</i>			
<i>Prunus spinosa</i>	Blackthorn	1+1tr 40-60cm	40-50%
<i>Rosa-canina</i>	Dog-rose	1+1tr 40-60cm	
<i>Euonymus europaeus</i>	Spindle	1+1tr 40-60cm	
<i>Salix aurita</i>	Eared Willow	1+1tr 40-60cm	40-50%
<i>Rubus fruticosus</i>	Bramble	1+1tr 40-60cm	

Prepared by:  
**MACRO WORKS,**  
HIBERNIA HOUSE,  
CHERRYWOOD BUSINESS PARK,  
LOUGHLINSTOWN, DUBLIN 18  
00353 (01) 2303585  
info@macroworks.ie

Site location:  
**BALLYCOSKERY,  
COUNTY CORK**

Drawing Title:  
**CORK LINE LEVEL CROSSINGS**

Project:  
**LANDSCAPE MITIGATION PLAN -  
XC212 BALLYCOSKERY**

Drawn by: CD Checked by: RB

Drawing Ref: **LD.CLLC.XC212**

Scale: 1:750 @ A1 Date: MARCH 2021

**ISSUED**

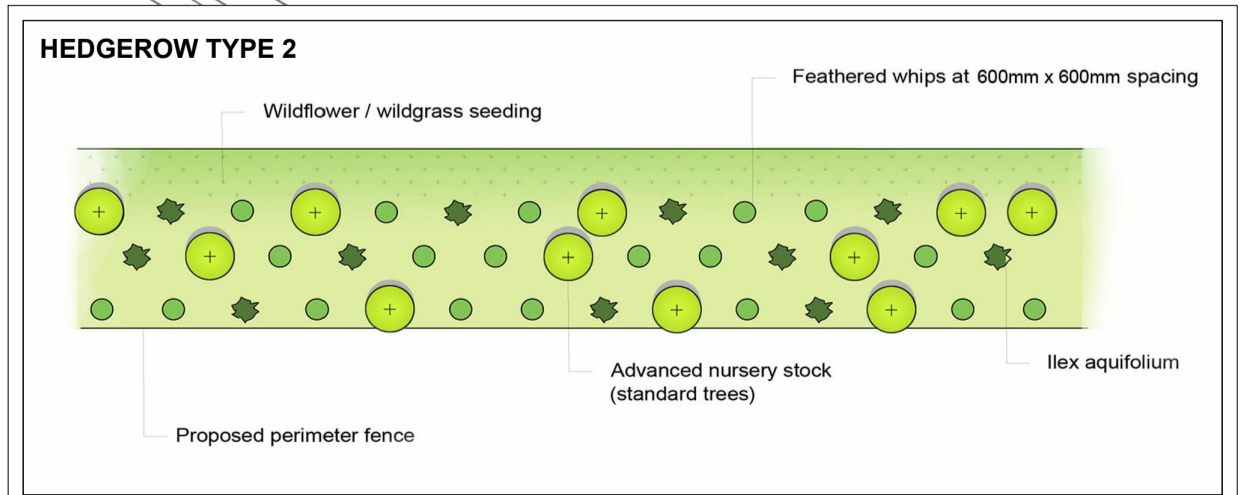
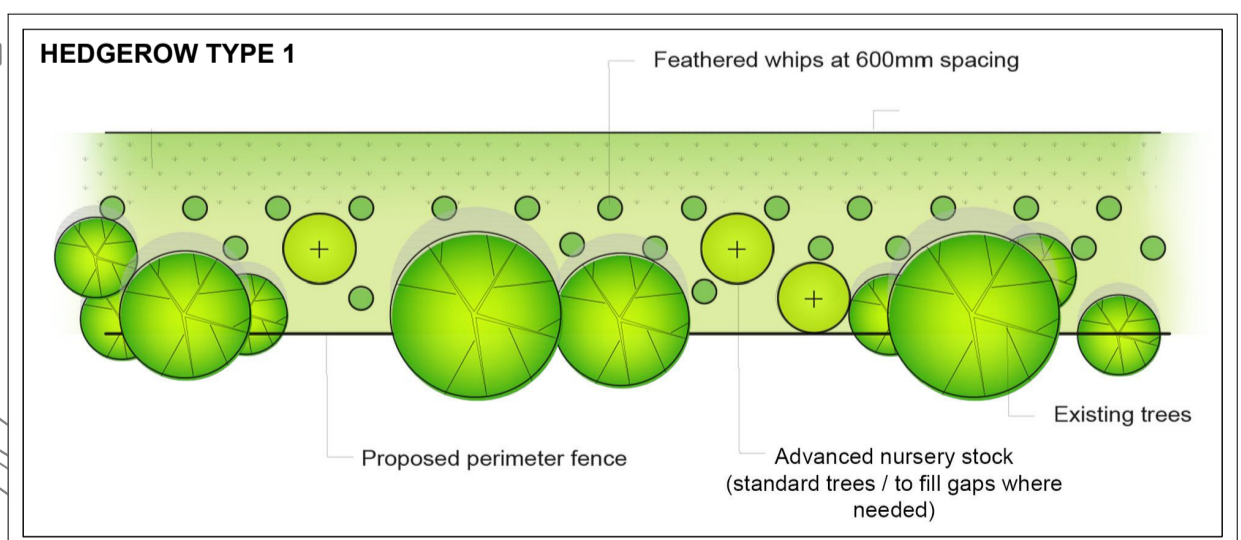
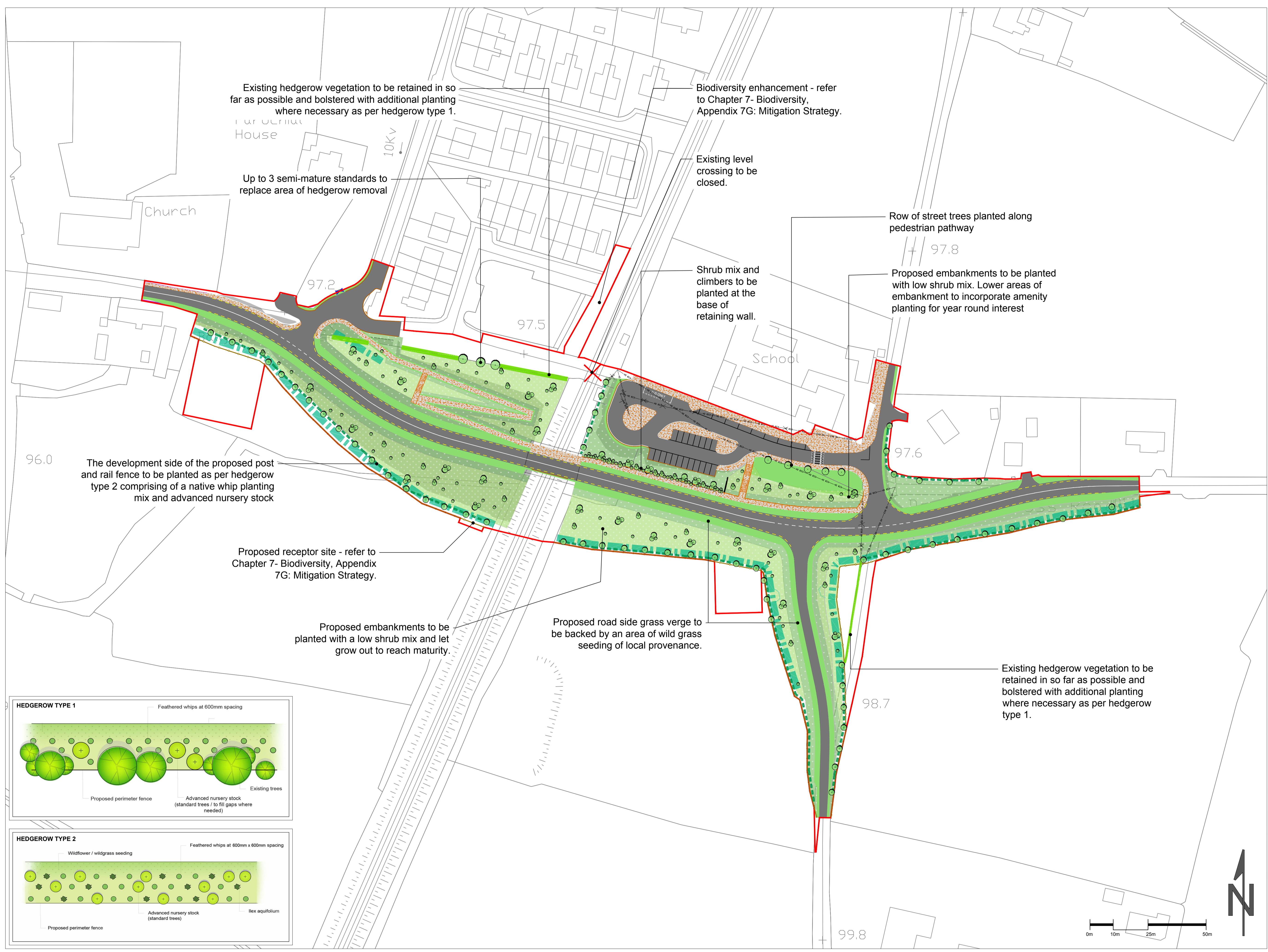

- Legend:**
- EXISTING HEDGEROW TO BE BOLSTERED (TYPE 1)
  - PROPOSED HEDGEROW (TYPE 2)
  - PROPOSED POST AND RAIL FENCE
  - PROPOSED SHRUB MIX
  - PROPOSED WILD GRASS SEEDING
  - PROPOSED ADVANCED NURSERY STOCK
  - PROPOSED SWALES
  - SITE BOUNDARY

**Notes:**  
The function of the proposed mitigation planting is primarily for screening, but it will also enhance the ecological corridors that area already present within the hedgerows.

**Hedgerows**  
Mitigation screen planting shall consist of a mixture of native hedgerow species that are prevalent in the immediate area. Planting to consist of feathered whips (of various sizes) and advanced nursery stock (where necessary) in staggered rows at a spacing of 600mm.

'Under-planting' to consist of a single row of whips to the development side of existing tree lines and hedgerows. 'Inter-planting' to consist of a triple staggered row of whips and advanced nursery stock at 600mm spacing.

All native species will be planted as whips, with the primary and secondary structure species to be of a minimum height of 80-100cm and the other shrub species to be of a minimum height of 40-60cm.

Proposed hedgerows to be planted as per diagram LMP1.1 and LMP1.2, and maintained at a height of 3-4m unless otherwise specified.

**Low Shrub mix**  
Low shrub species mix to comprise of Low-canopy: Sub-dominants (<10%), Understorey and Fringe: High-Shrubs (40-50%) and Understorey and Edge: Lower-Shrubs (40%-50%). Planting on embankments to be allowed to grow to reach maturity and to be concentrated on the lower portions of the embankments, as identified on the landscape plan.

High-Shrubs planted with spacing of between 900mm and 1500mm, while lower-shrubs are to be planted between 750mm and 900mm centres.

**Wild Grass Seeding**  
Wild grass seeding of local provenance to be planted along the roadside verge.

Species mix to be finalised in conjunction with the project ecologist. All species to be from certified native stock and preferably from an approved supplier of the Green, Low-Carbon, Agri Environment Scheme (GLAS).

**NATIVE HEDGEROW SPECIES:**

Botanical name	Common name	Size	%
<i>Primary structure:</i>			
<i>Crataegus monogyna</i>	Hawthorn	1+2tr 80-100cm 10-15cm girth 5m or standard trees	60%
<i>Secondary structure:</i>			
<i>Prunus spinosa</i>	Blackthorn	1+2tr 80-100cm	15%
<i>Ilex aquifolium</i>	Holly	1+2tr 80-100cm	15%
<i>Shrub species structure:</i>			
<i>Rubus fruticosus</i>	Bramble	1+1tr 40-60cm	2.5%
<i>Corylus avellana</i>	Hazel	1+1tr 40-60cm	2.5%
<i>Rosa canina</i>	Dog-rose	1+1tr 40-60cm	2.5%
<i>Euonymus europaeus</i>	Spindle	1+1tr 40-60cm	2.5%

**LOW SHRUB MIX:**

Botanical name	Common name	Size	%
<i>Low Canopy (Sub-dominants):</i>			
<i>Ainus glutinosa</i>	Alder	Feathered Trees 200-300cm Standard trees 200-300cm	<10%
<i>Betula pubescens</i>	Downy Birch	Feathered Trees 200-300cm Standard trees 200-300cm	
<i>Prunus avium</i>	Wild Cherry	1+1tr 80-100cm, bare root	
<i>Understorey and fringe (higher shrubs):</i>			
<i>Prunus Padus</i>	Bird Cherry	1+1tr 90-120cm	40-50%
<i>Prunus avellana</i>	Hazel	1+1tr 90-120cm	
<i>Ilex aquifolium</i>	Holly	1+1tr 90-120cm	
<i>Crataegus monogyna</i>	Hawthorn	1+1tr 90-120cm	
<i>Salix caprea</i>	Goat Willow	1+1tr 90-120cm	
<i>Salix purpurea</i>	Purple Willow	1+1tr 90-120cm	
<i>Understorey and edge (lower shrubs):</i>			
<i>Prunus spinosa</i>	Blackthorn	1+1tr 40-60cm	40-50%
<i>Rosa-canina</i>	Dog-rose	1+1tr 40-60cm	
<i>Euonymus europaeus</i>	Spindle	1+1tr 40-60cm	
<i>Salix aurita</i>	Eared Willow	1+1tr 40-60cm	
<i>Rubus fruticosus</i>	Bramble	1+1tr 40-60cm	

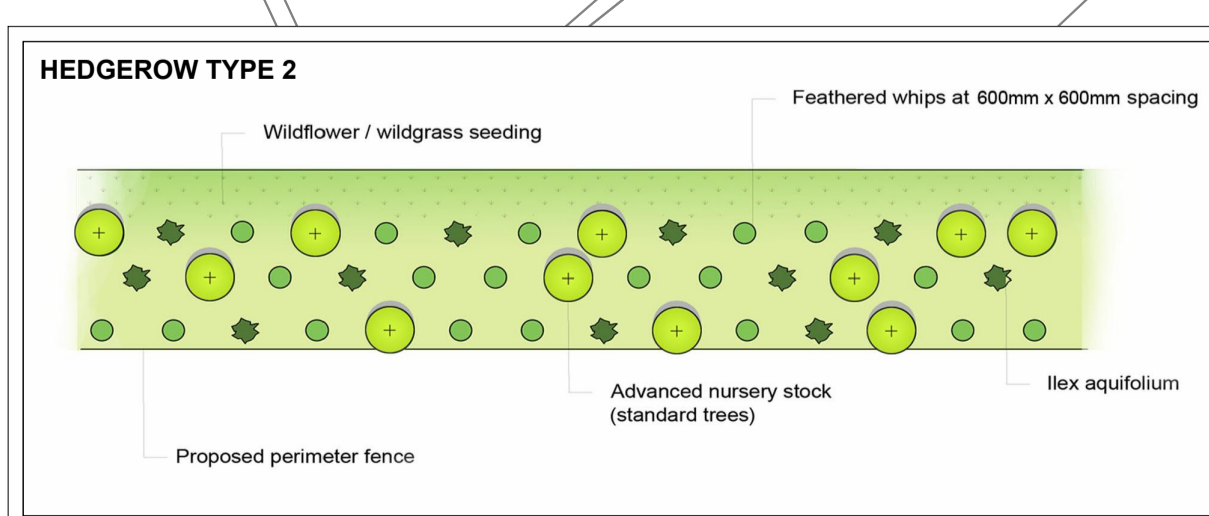
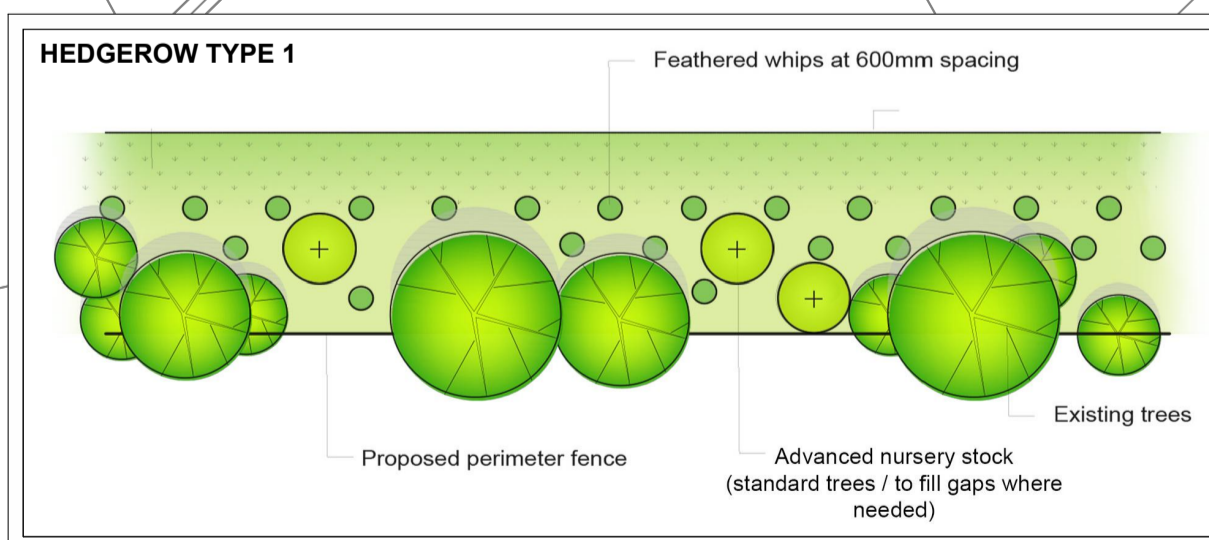
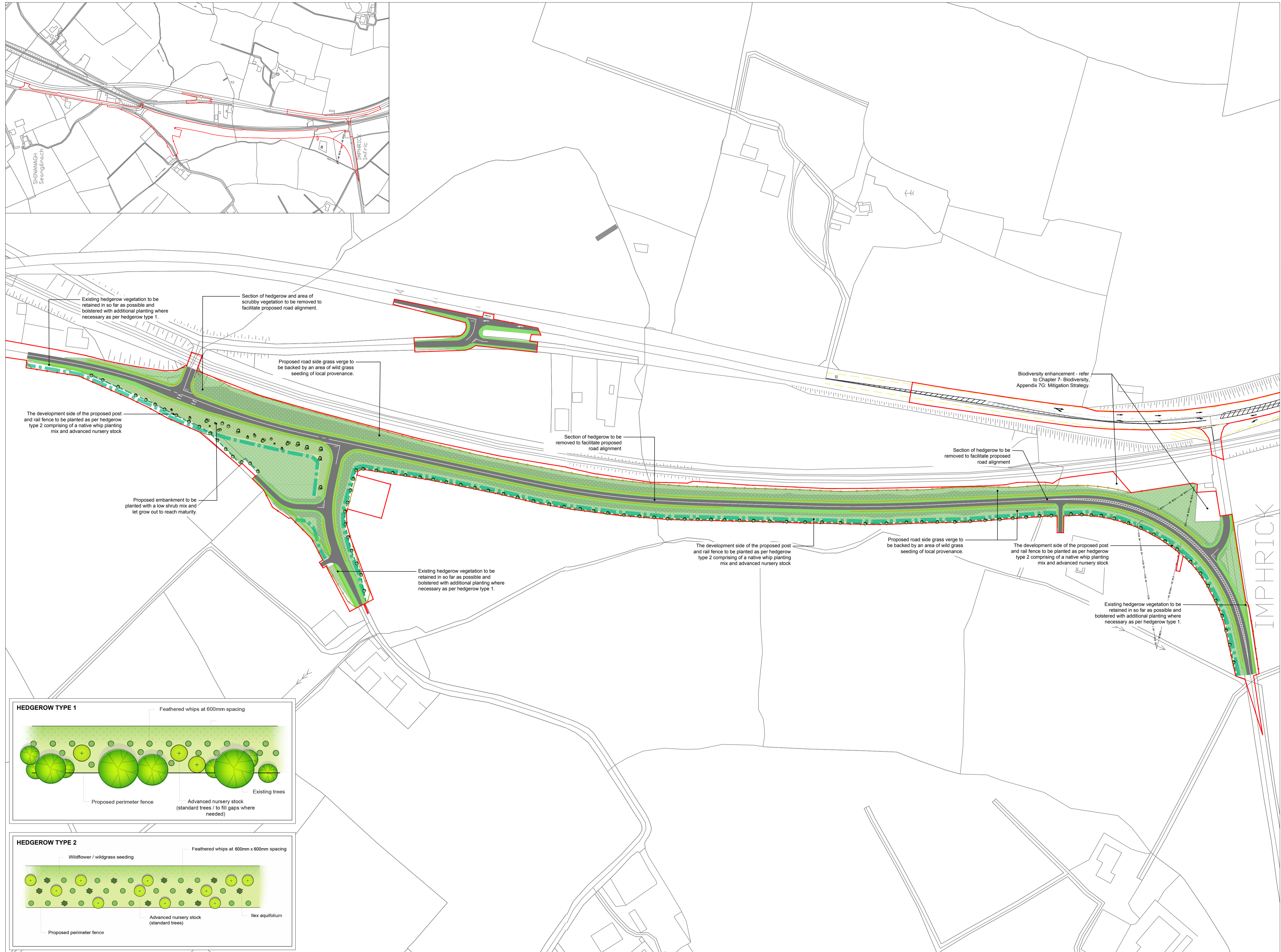

Prepared by:  
**MACRO WORKS,**  
HIBERNIA HOUSE,  
CHERRYWOOD BUSINESS PARK,  
LOUGHLINSTOWN, DUBLIN 16  
00353 (01) 230585  
info@macroworks.ie

Site location:  
**SHINANAGH,  
COUNTY CORK**

Drawing Title:  
**CORK LINE LEVEL CROSSINGS**

Project:  
**LANDSCAPE MITIGATION PLAN -  
XC215 SHINANAGH**

Drawn by:  
CD

Checked by:  
RB

Drawing Ref:  
**LD.CLLC.XC215**

Scale:  
1:1500 @ A1

Date:  
MARCH 2021

**ISSUED**

- Legend:**
- EXISTING HEDGEROW TO BE BOLSTERED (TYPE 1)
  - PROPOSED HEDGEROW (TYPE 2)
  - PROPOSED POST AND RAIL FENCE
  - PROPOSED SHRUB MIX
  - PROPOSED WILD GRASS SEEDING
  - PROPOSED ADVANCED NURSERY STOCK
  - PROPOSED SWALES
  - SITE BOUNDARY

**Notes:**  
The function of the proposed mitigation planting is primarily for screening, but it will also enhance the ecological corridors that are already present within the hedgerows.

**Hedgerows**  
Mitigation screen planting shall consist of a mixture of native hedgerow species that are prevalent in the immediate area. Planting to consist of feathered whips (of various sizes) and advanced nursery stock (where necessary) in staggered rows at a spacing of 600mm.

'Under-planting' to consist of a single row of whips to the development side of existing tree lines and hedgerows. 'Inter-planting' to consist of a triple staggered row of whips and advanced nursery stock at 600mm spacing.

All native species will be planted as whips, with the primary and secondary structure species to be of a minimum height of 80-100cm and the other shrub species to be of a minimum height of 40-60cm.

Proposed hedgerows to be planted as per diagram LMP1.1 and LMP1.2, and maintained at a height of 3-4m unless otherwise specified.

**Low Shrub mix**  
Low shrub species mix to comprise of Low-canopy: Sub-dominants (<10%), Understorey and Fringe: High-Shrubs (40-50%) and Understorey and Edge: Lower-Shrubs (40%-50%). Planting on embankments to be allowed to grow to reach maturity and to be concentrated on the lower portions of the embankments, as identified on the landscape plan.

**High-Shrubs** planted with spacing of between 900mm and 1500mm, while lower-shrubs are to be planted between 750mm and 900mm centres.

**Wild Grass Seeding**  
Wild grass seeding of local provenance to be planted along the roadside verge.

Species mix to be finalised in conjunction with the project ecologist. All species to be from certified native stock and preferably from an approved supplier of the Green, Low-Carbon, Agri Environment Scheme (GLAS).

**NATIVE HEDGEROW SPECIES:**

Botanical name	Common name	Size	%
<i>Primary structure:</i>			
<i>Crataegus monogyna</i>	Hawthorn	1+2tr 80-100cm 10-12cm girth 5m or standard trees	60%
<i>Secondary structure:</i>			
<i>Prunus spinosa</i>	Blackthorn	1+2tr 80-100cm	15%
<i>Ilex aquifolium</i>	Holly	1+2tr 80-100cm	15%
<i>Shrub species structure:</i>			
<i>Rubus fruticosus</i>	Bramble	1+1tr 40-60cm	2.5%
<i>Corylus avellana</i>	Hazel	1+1tr 40-60cm	2.5%
<i>Rosa canina</i>	Dog-rose	1+1tr 40-60cm	2.5%
<i>Euonymus europaeus</i>	Spindle	1+1tr 40-60cm	2.5%

**LOW SHRUB MIX:**

Botanical name	Common name	Size	%
<i>Low Canopy (Sub-dominants):</i>			
<i>Ainus glutinosa</i>	Alder	Feathered Trees 200-300cm	<10%
<i>Betula pubescens</i>	Downy Birch	Feathered Trees 200-300cm	
<i>Prunus avium</i>	Wild Cherry	1+1tr 80-100cm, bare root	
<i>Understorey and fringe (higher shrubs):</i>			
<i>Prunus Padus</i>	Bird Cherry	1+1tr 90-120cm	40-50%
<i>Corylus avellana</i>	Hazel	1+1tr 90-120cm	
<i>Ilex aquifolium</i>	Holly	1+1tr 90-120cm	
<i>Crataegus monogyna</i>	Hawthorn	1+1tr 90-120cm	40-50%
<i>Salix caprea</i>	Goat Willow	1+1tr 90-120cm	
<i>Salix purpurea</i>	Purple Willow	1+1tr 90-120cm	
<i>Understorey and edge (lower shrubs):</i>			
<i>Prunus spinosa</i>	Blackthorn	1+1tr 40-60cm	40-50%
<i>Rosa-canina</i>	Dog-rose	1+1tr 40-60cm	
<i>Euonymus europaeus</i>	Spindle	1+1tr 40-60cm	
<i>Salix aurita</i>	Eared Willow	1+1tr 40-60cm	40-50%
<i>Rubus fruticosus</i>	Bramble	1+1tr 40-60cm	

Prepared by: MACRO WORKS, HIBERNIA HOUSE, CHERRYWOOD BUSINESS PARK, LOUGHLINSTOWN, DUBLIN 16 00363 (01) 2303585 info@macroworks.ie

Site location: BUTTEVANT, COUNTY CORK

Drawing Title: CORK LINE LEVEL CROSSINGS

Project: LANDSCAPE MITIGATION PLAN - XC219 BUTTEVANT GATES

Drawn by: CD Checked by: RB

Drawing Ref: LD.CLLC.XC219

Scale: 1:750 @ A1 Date: MARCH 2021

ISSUED

