

PLAN 4A (i)
XC212 - BALLYCOSKERY

NOTES:
1. ALL DIMENSIONS ARE IN METRES UNLESS OTHERWISE STATED

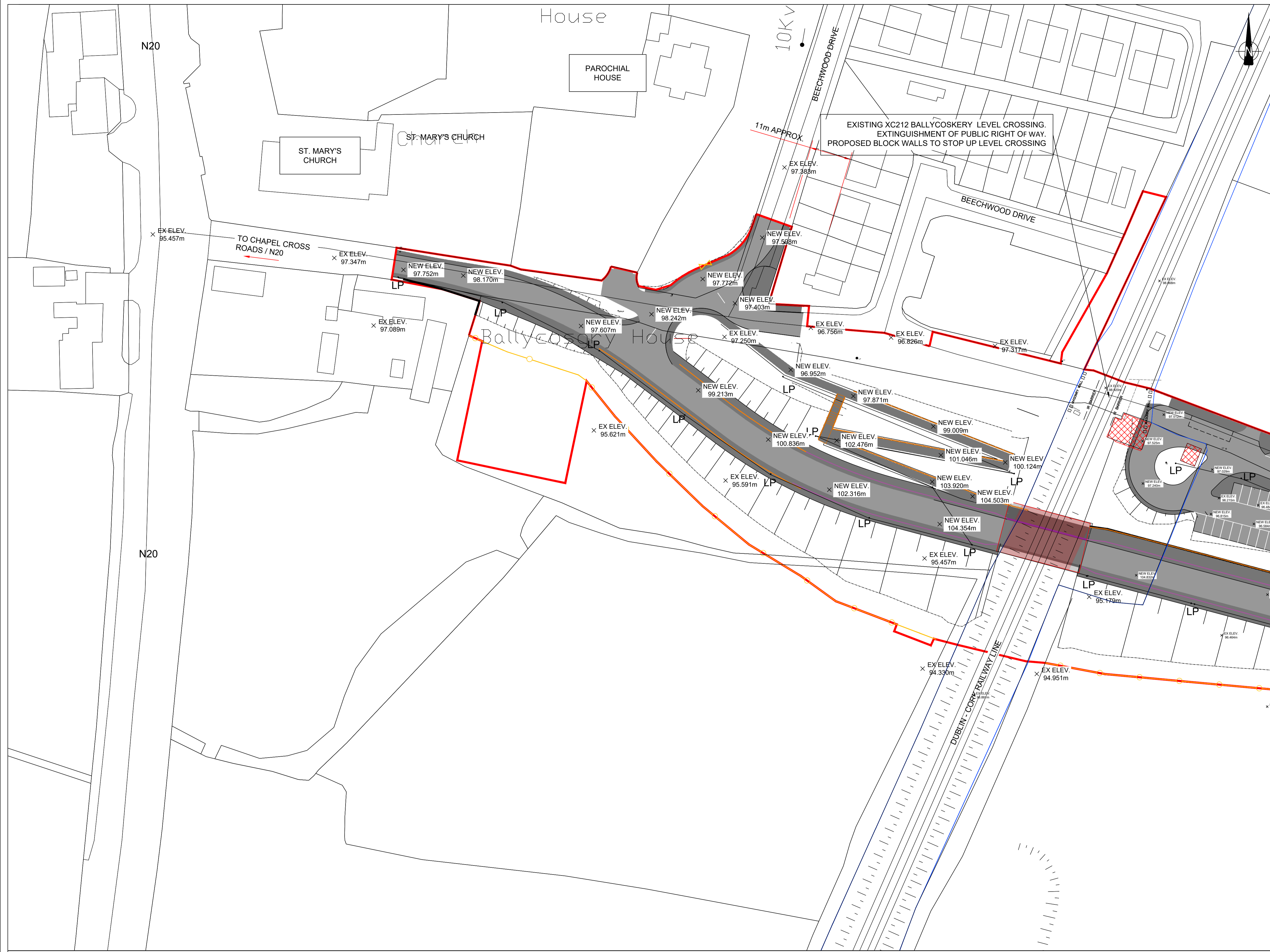

LEGEND

- PROPOSED ROAD ALIGNMENT
- PROPOSED PAVEMENT
- PROPOSED STRUCTURE
- PROPOSED BUILDINGS TO BE DEMOLISHED
- WAYLEAVE - RIGHT OF WAY
- RED LINE BOUNDARY
- IRISH RAIL LAND OWNERSHIP
- PROPOSED SAFETY BARRIER
- PROPOSED PEDESTRIAN GUARDRAIL
- PROPOSED FENCELINE
- PROPOSED GATE
- LAMP POST
- MASONRY WALL
- PROPOSED MASONRY WALL
- IR BARRIER
- EXISTING IR BARRIER
- PALISADE GATE
- PALISADE GATE

DRAWING PREPARED BY:
NAME: JOHN ROCKS
COMPANY: JACOBS ENGINEERING UK LTD.
ADDRESS: SECOND FLOOR, ROCHESTER BUILDING, 28 ADELAIDE STREET, BELFAST

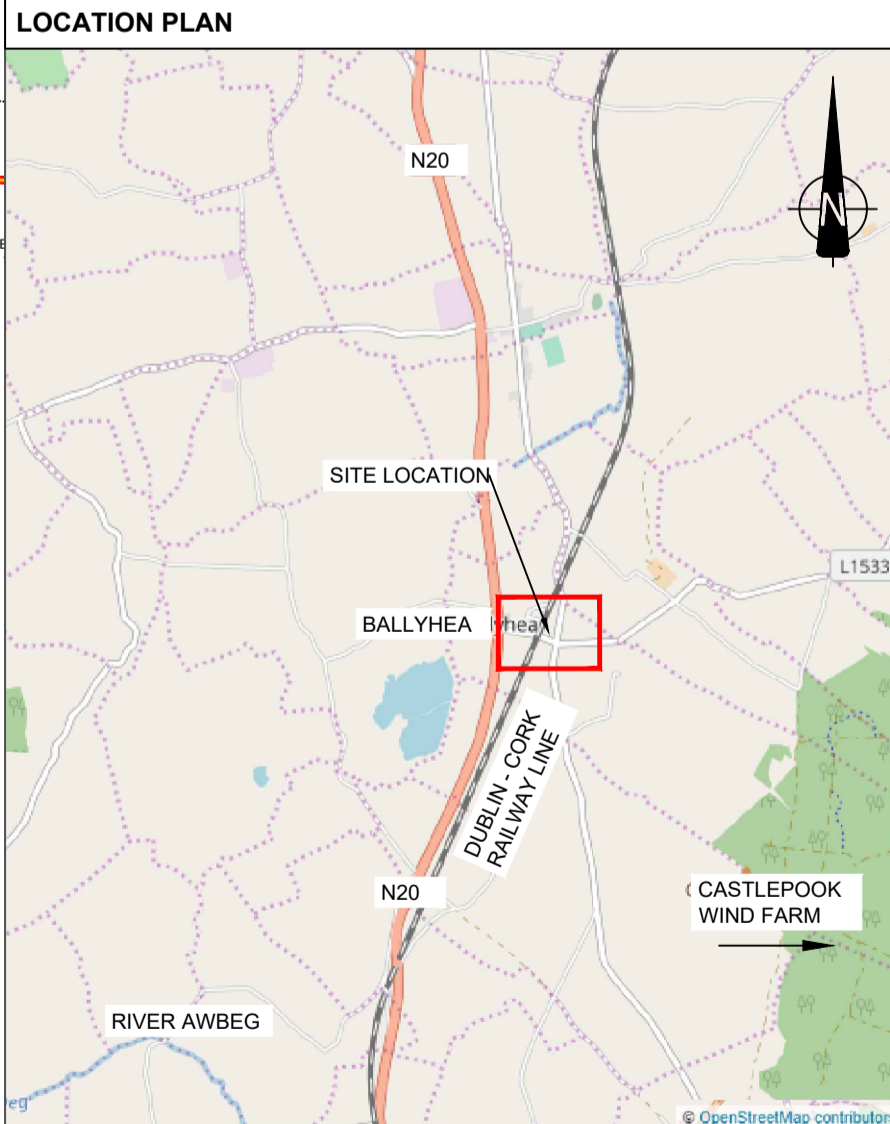

SCALE 1:50,000
© Ordnance Survey Ireland. All rights reserved. Licence number EN 0039719



Rev	By	Date	Description
0	JR	NOV '20	DRAFT ISSUE FOR COMMENT
1	AB	Apr '21	FINAL

Project:	CORK LINE LEVEL CROSSINGS		
Component:	RAILWAY ORDER SCHEDULE DRAWING		
Title:	PROPOSED SITE PLAN - XC212 BALLYCOSKERY - SHEET 1 OF 2		
Design:	SK	File Name:	-
Drawn:	JR	Original scales:	PLAN 1:500 @ A1
Checked:	FMD	Date:	NOV '20
Drawing No.:	32111000-JAC-LUH-XC212-DR-CH-0004(i)		