



LEGEND

NEW STATION

EXISTING STATION

UPGRADED STATION

NEW DEPOT

CLOSURE OF LEVEL CROSSING

PARK & RIDE

EXISTING RAILWAY LINE

EXISTING RAILWAY LINE TO BE ELECTRIFIED WITH OVERHEAD LINES

© Irish Rail (2022). This drawing is confidential and the copyright in it is owned by Irish Rail. This drawing must not be either loaned, copied or otherwise reproduced in whole or in part or used for any purpose without the prior permission of Irish Rail.

© Ordnance Survey Ireland and government of Ireland. All O.S. Data used for plans are printed under: "Copyright Ordnance Survey Ireland" Survey No. 0039722. (OSI Aerial Data or OSI Lidar Data) & Survey No. 2022/OSI_NMA_180 (OSI Vector Data).

All elevations are in metres and relate to OSI Geoid Model (OSGM02) Malin Head as defined by existing Project Control. All Co-ordinates are in Irish Transverse Mercator Grid (ITM) as defined by OSI active GPS station Tallaght College (TLLG).

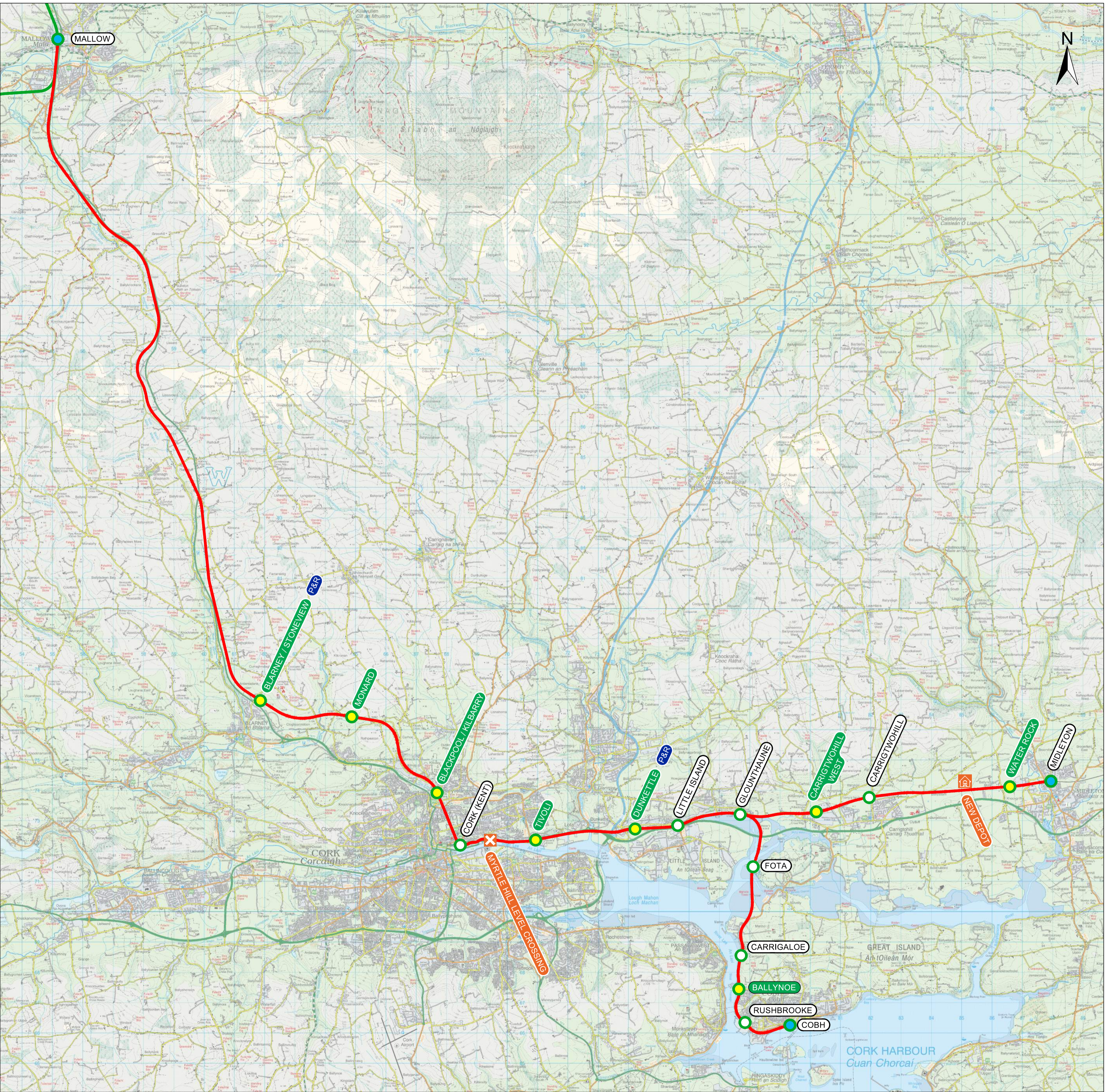

Rialtas na hÉireann
Government of Ireland

Tionscadal Éireann
Project Ireland
2040

Iarnród Éireann
Irish Rail

Project Title:







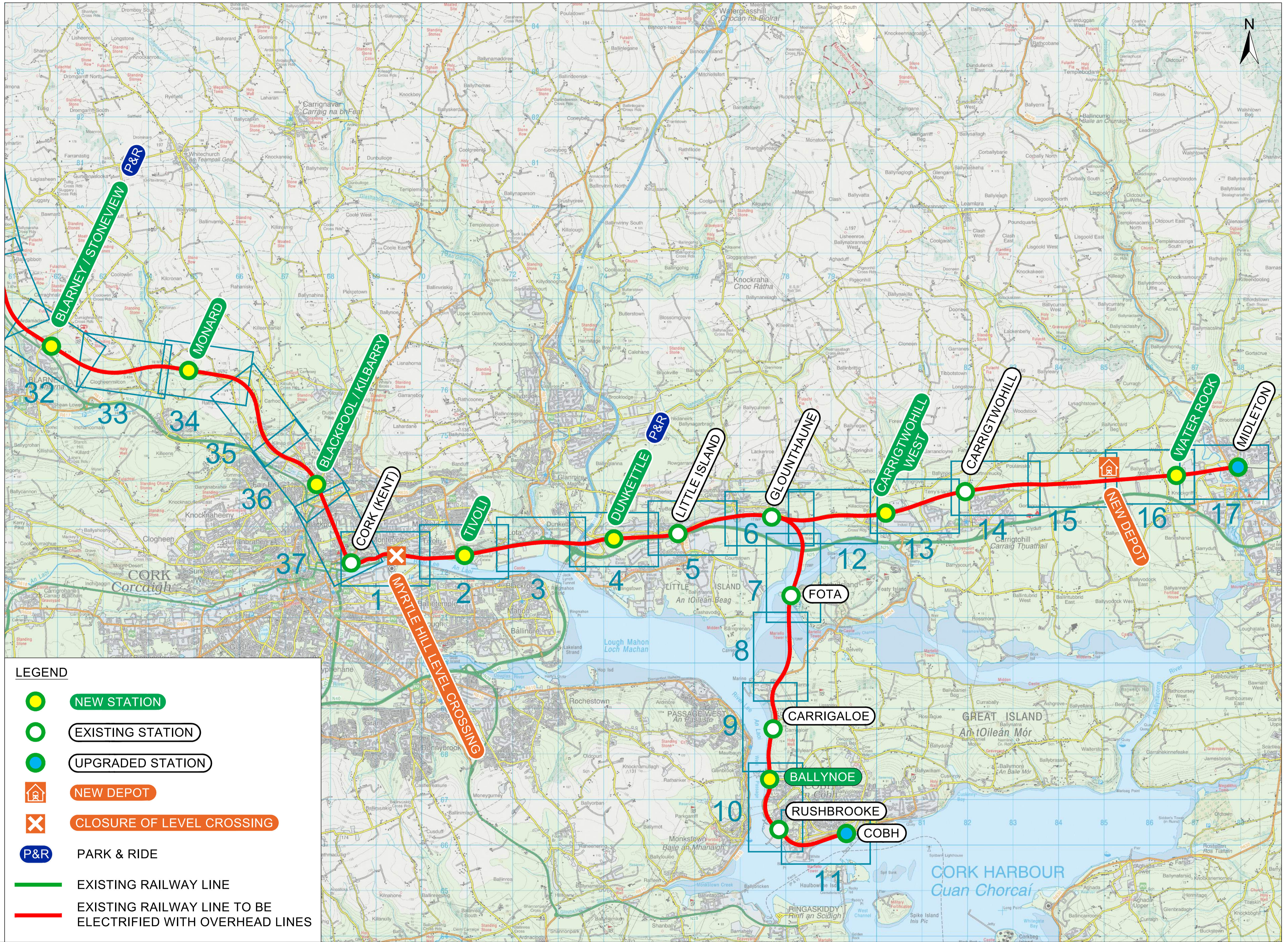
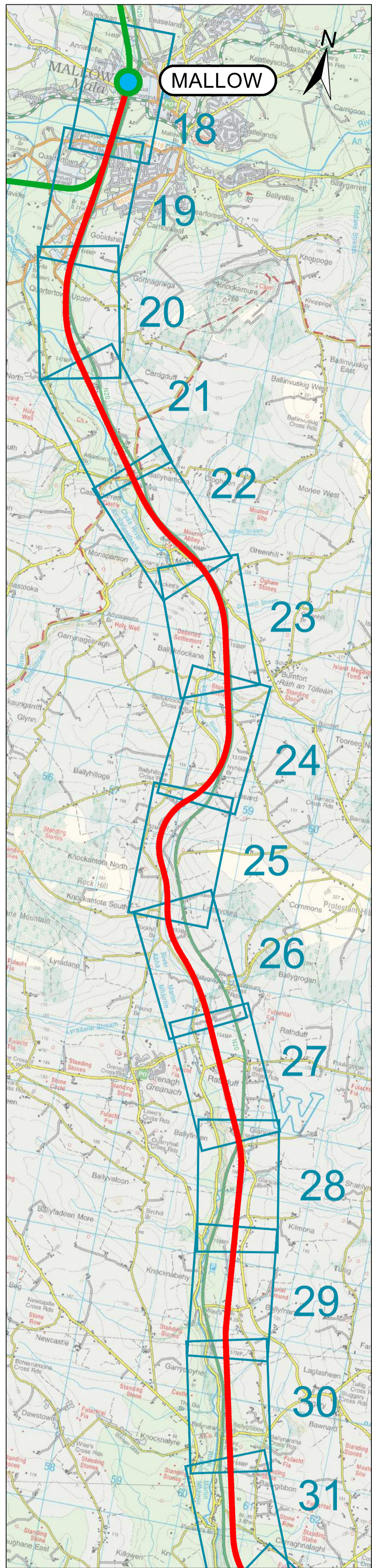

CORK AREA COMMUTER RAIL PROGRAMME
(Main Works)

Figure Number:

LOCATION PLAN



LEGEND

-  NEW STATION
-  EXISTING STATION
-  UPGRADED STATION
-  NEW DEPOT
-  CLOSURE OF LEVEL CROSSING
-  PARK & RIDE
-  EXISTING RAILWAY LINE
-  EXISTING RAILWAY LINE TO BE ELECTRIFIED WITH OVERHEAD LINES

© Irish Rail (2022). This drawing is confidential and the copyright in it is owned by Irish Rail. This drawing must not be either loaned, copied or otherwise reproduced in whole or in part or used for any purpose without the prior permission of Irish Rail.

© Ordnance Survey Ireland and government of Ireland. All O.S. Data used for plans are printed under "Copyright Ordnance Survey Ireland" Survey No. 0039722 (OSI Aerial Data or OSI Lidar Data) & Survey No. 2022/OSI NMA 180 (OSI Vector Data).

All elevations are in metres and relate to OSI Geoid Model (OSGM02) Malin Head as defined by existing Project Control.

All Co-ordinates are in Irish Transverse Mercator Grid (ITM) as defined by OSI active GPS station Tallaght College (TLLG).



Rialtas na hÉireann
Government of Ireland

Tionscadal Éireann
Project Ireland
2040



NTA
National Transport Authority



TUC RAIL



TYP SA FIOD
FOURN & O'DONOVAN

Project Title:
CORK AREA COMMUTER RAIL PROGRAMME
(Main Works)

Figure Number:
KEY PLAN

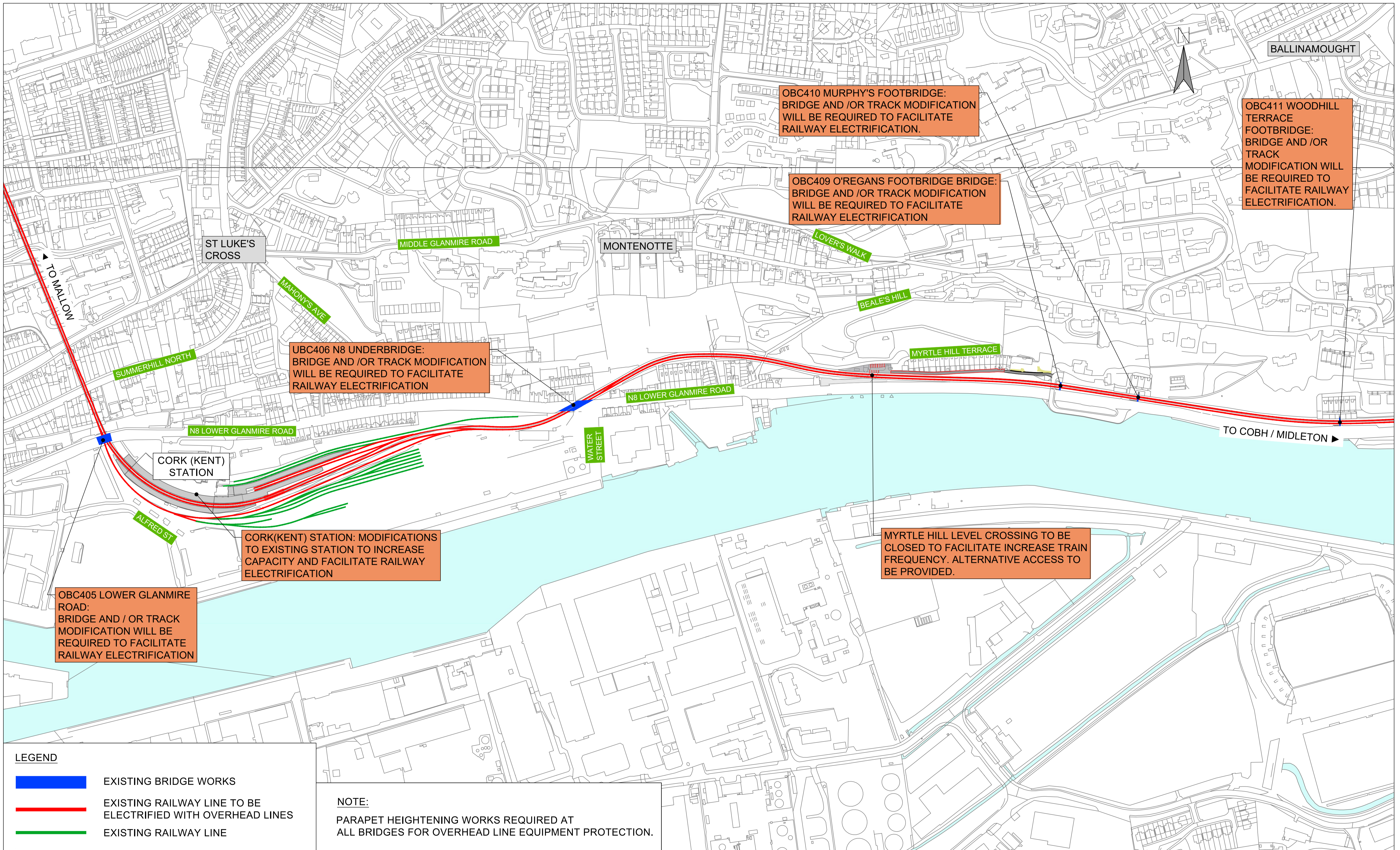

© Irish Rail (2022). This drawing is confidential and the copyright in it is owned by Irish Rail. This drawing must not be either loaned, copied or otherwise reproduced in whole or in part or used for any purpose without the prior permission of Irish Rail.
© Ordnance Survey Ireland and government of Ireland. All O.S. Data used for plans are printed under: "Copyright Ordnance Survey Ireland" Survey No. 0039722 (OSI Aerial Data or OSI Lidar Data) & Survey No. 2022/OSI_NMA_180 (OSI Vector Data).
All elevations are in metres and relate to OSI Geoid Model (OSGM02) Malin Head as defined by existing Project Control.
All Co-ordinates are in Irish Transverse Mercator Grid (ITM) as defined by OSI active GPS station Tallaght College (TLLG).



Rialtas na hÉireann
Government of Ireland
Tionscadal Éireann
Project Ireland
2040



NTA
Gairne Náisiúnta Iomparáil
National Transport Authority



Project Title:
CORK AREA COMMUTER RAIL PROGRAMME
(Main Works)

Figure Number:
FIGURE 001

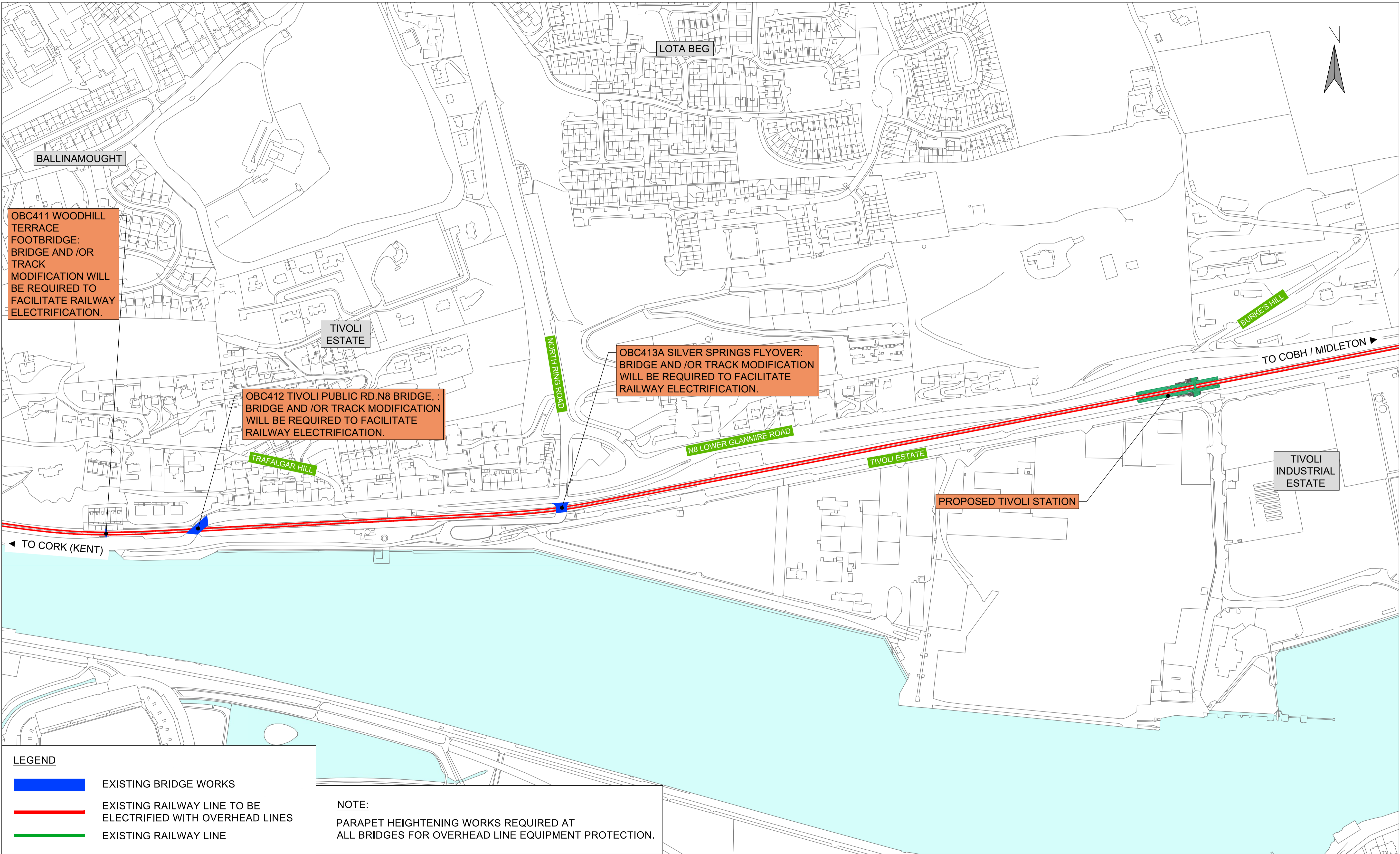

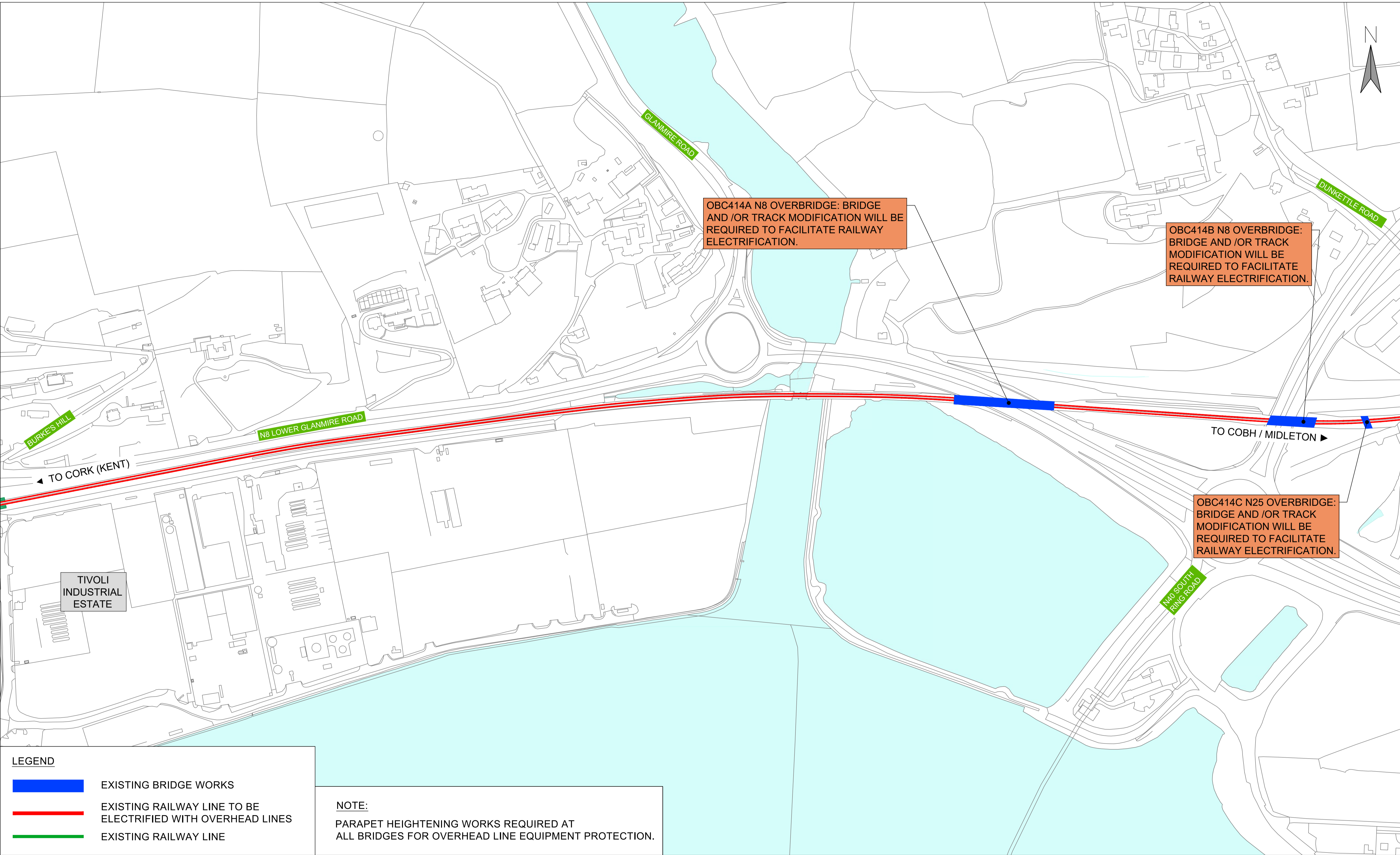

© Irish Rail (2022). This drawing is confidential and the copyright in it is owned by Irish Rail. This drawing must not be either loaned, copied or otherwise reproduced in whole or in part or used for any purpose without the prior permission of Irish Rail.

© Ordnance Survey Ireland and government of Ireland. All O.S. Data used for plans are printed under: "Copyright Ordnance Survey Ireland" Survey No. 0039722. (OSi Aerial Data or OSi Lidar Data) & Survey No. 2022/OSi NMA 180 (OSi Vector Data).

All elevations are in metres and relate to OSi Geoid Model (OSGM02) Malin Head as defined by existing Project Control. All Co-ordinates are in Irish Transverse Mercator Grid (ITM) as defined by OSi active GPS station Tallaght College (TLLG).



Project Title:
CORK AREA COMMUTER RAIL PROGRAMME
(Main Works)

Figure Number:
FIGURE 003

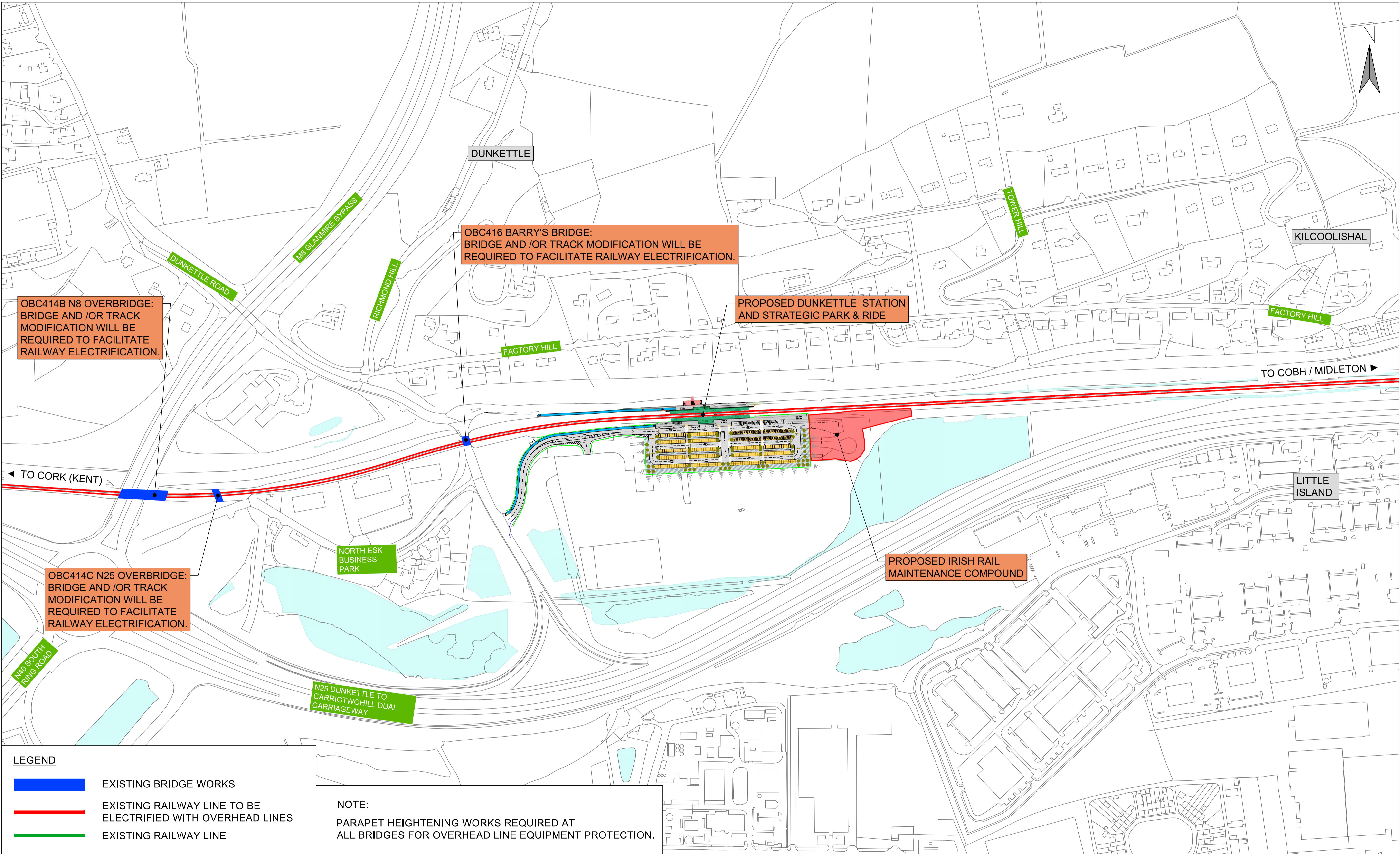

© Irish Rail (2022). This drawing is confidential and the copyright in it is owned by Irish Rail. This drawing must not be either loaned, copied or otherwise reproduced in whole or in part or used for any purpose without the prior permission of Irish Rail.

© Ordnance Survey Ireland and government of Ireland. All O.S. Data used for plans are printed under: "Copyright Ordnance Survey Ireland" Survey No. 0039722. (OSI Aerial Data or OSI Lidar Data) & Survey No. 2022/OSI_NMA_180 (OSI Vector Data).

All elevations are in metres and relate to OSI Geoid Model (OSGM02) Malin Head as defined by existing Project Control. All Co-ordinates are in Irish Transverse Mercator Grid (ITM) as defined by OSI active GPS station Tallaght College (TLLG).



Project Title: CORK AREA COMMUTER RAIL PROGRAMME (Main Works)

Figure Number: FIGURE 004

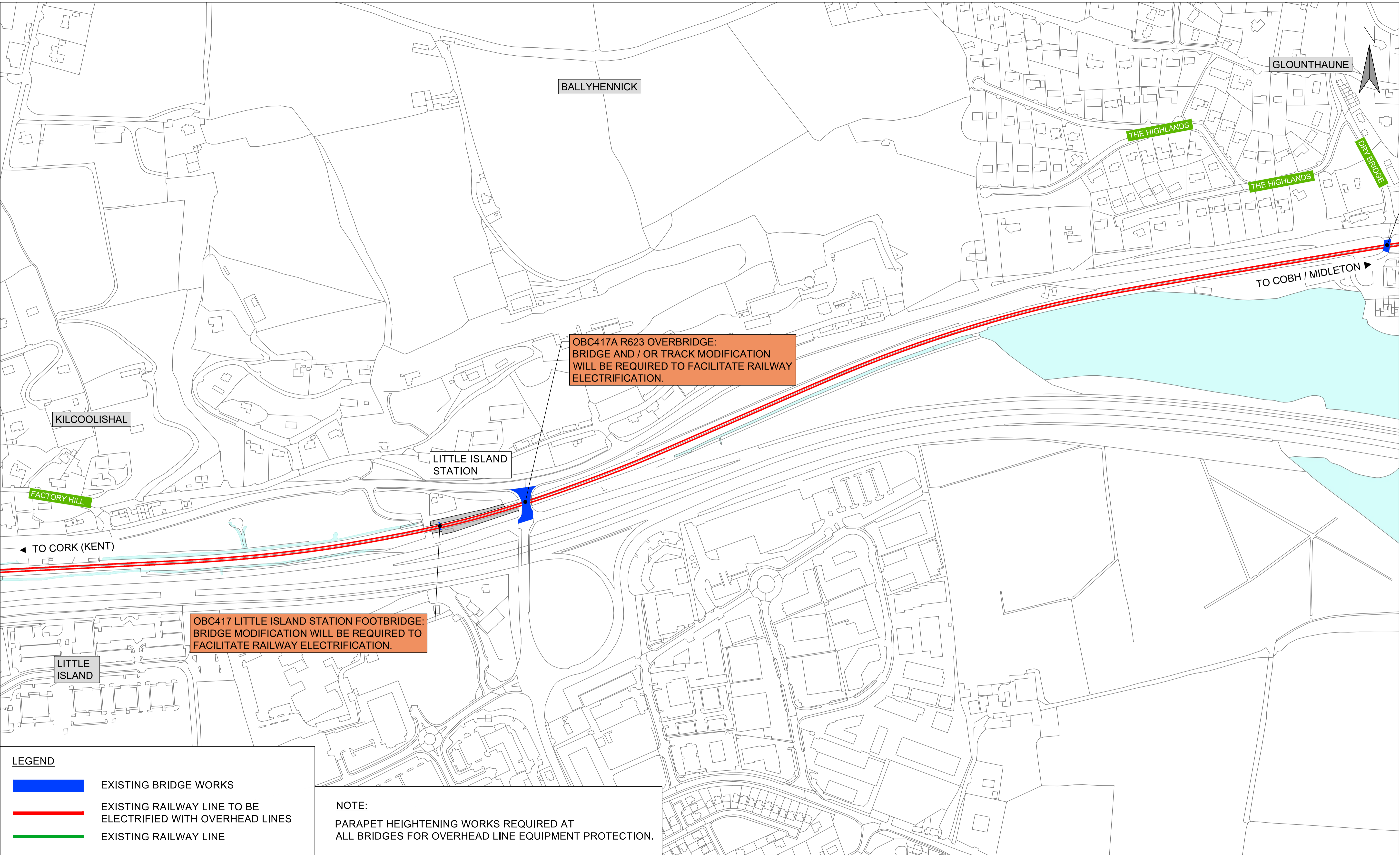

© Irish Rail (2022). This drawing is confidential and the copyright in it is owned by Irish Rail. This drawing must not be either loaned, copied or otherwise reproduced in whole or in part or used for any purpose without the prior permission of Irish Rail.

© Ordnance Survey Ireland and government of Ireland. All O.S. Data used for plans are printed under: "Copyright Ordnance Survey Ireland" Survey No. 0039722. (OSI Aerial Data or OSI Lidar Data) & Survey No. 2022/OSI_NMA_180 (OSI Vector Data).

All elevations are in metres and relate to OSI Geoid Model (OSGM02) Malin Head as defined by existing Project Control.

All Co-ordinates are in Irish Transverse Mercator Grid (ITM) as defined by OSI active GPS station Tallaght College (TLLG).



Project Title: CORK AREA COMMUTER RAIL PROGRAMME (Main Works)

Figure Number: FIGURE 005

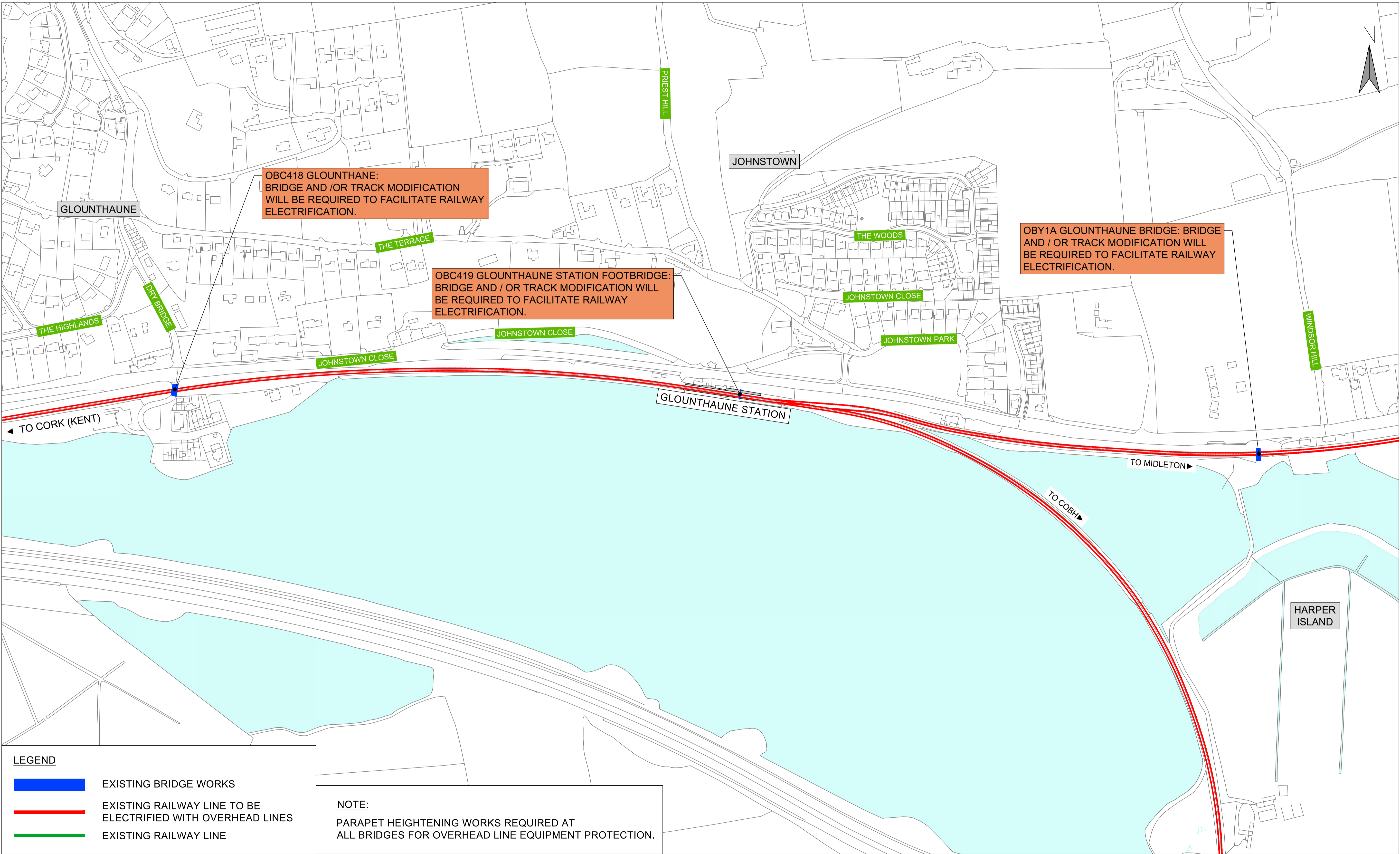

© Irish Rail (2022). This drawing is confidential and the copyright in it is owned by Irish Rail. This drawing must not be either loaned, copied or otherwise reproduced in whole or in part or used for any purpose without the prior permission of Irish Rail.
© Ordnance Survey Ireland and government of Ireland. All O.S. Data used for plans are printed under: "Copyright Ordnance Survey Ireland" Survey No. 0039722. (OSi Aerial Data or OSi Lidar Data) & Survey No. 2022/OSi NMA 180 (OSi Vector Data).
All elevations are in metres and relate to OSi Geoid Model (OSGM02) Malin Head as defined by existing Project Control.
All Co-ordinates are in Irish Transverse Mercator Grid (ITM) as defined by OSi active GPS station Tallaght College (TLLG).



Project Title: CORK AREA COMMUTER RAIL PROGRAMME (Main Works)

Figure Number: FIGURE 006

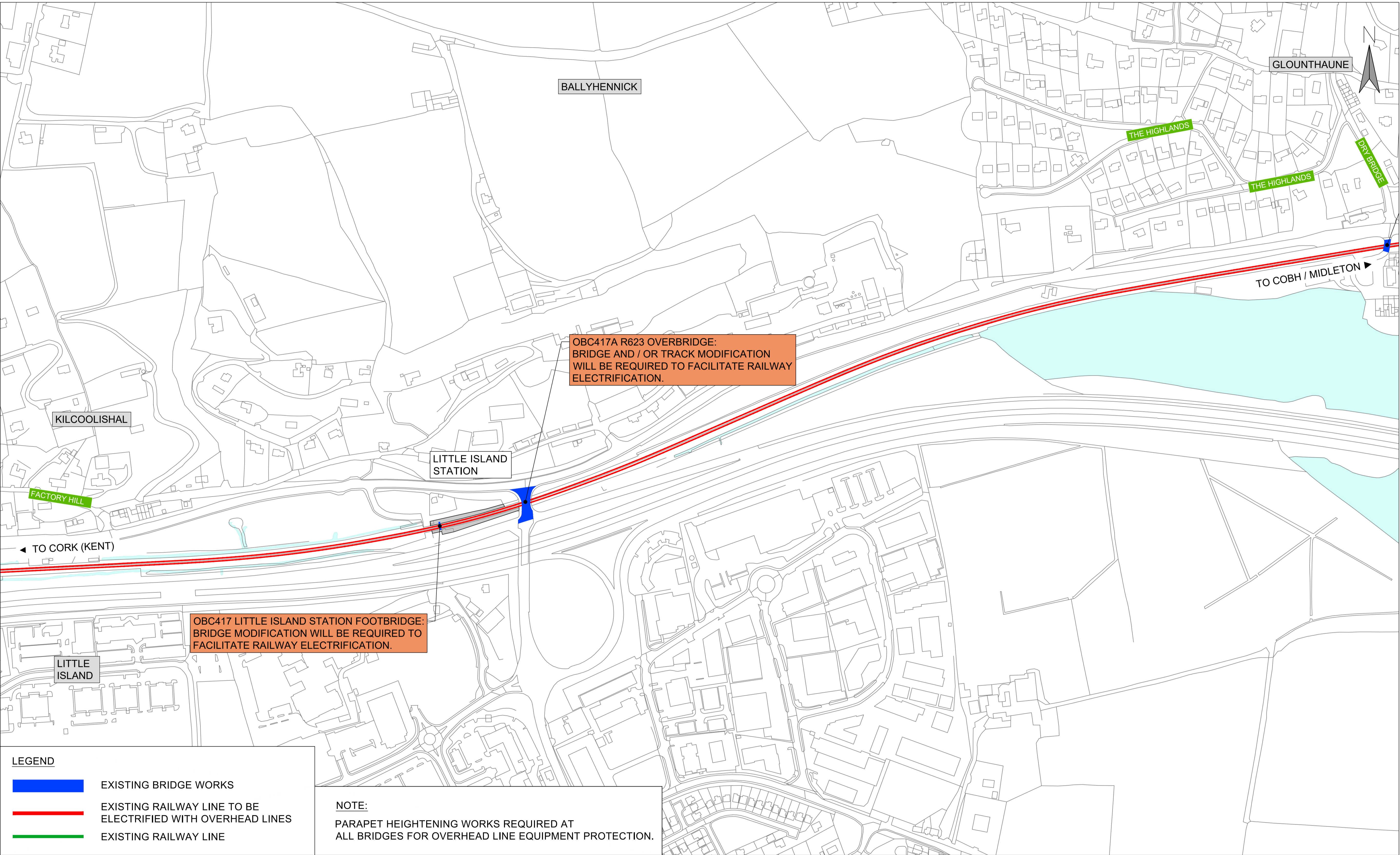

© Irish Rail (2022). This drawing is confidential and the copyright in it is owned by Irish Rail. This drawing must not be either loaned, copied or otherwise reproduced in whole or in part or used for any purpose without the prior permission of Irish Rail.

© Ordnance Survey Ireland and government of Ireland. All O.S. Data used for plans are printed under: "Copyright Ordnance Survey Ireland" Survey No. 0039722. (OSI Aerial Data or OSI Lidar Data) & Survey No. 2022/OSI_NMA_180 (OSI Vector Data).

All elevations are in metres and relate to OSI Geoid Model (OSGM02) Malin Head as defined by existing Project Control.

All Co-ordinates are in Irish Transverse Mercator Grid (ITM) as defined by OSI active GPS station Tallaght College (TLLG).



Project Title: CORK AREA COMMUTER RAIL PROGRAMME (Main Works)

Figure Number: FIGURE 005

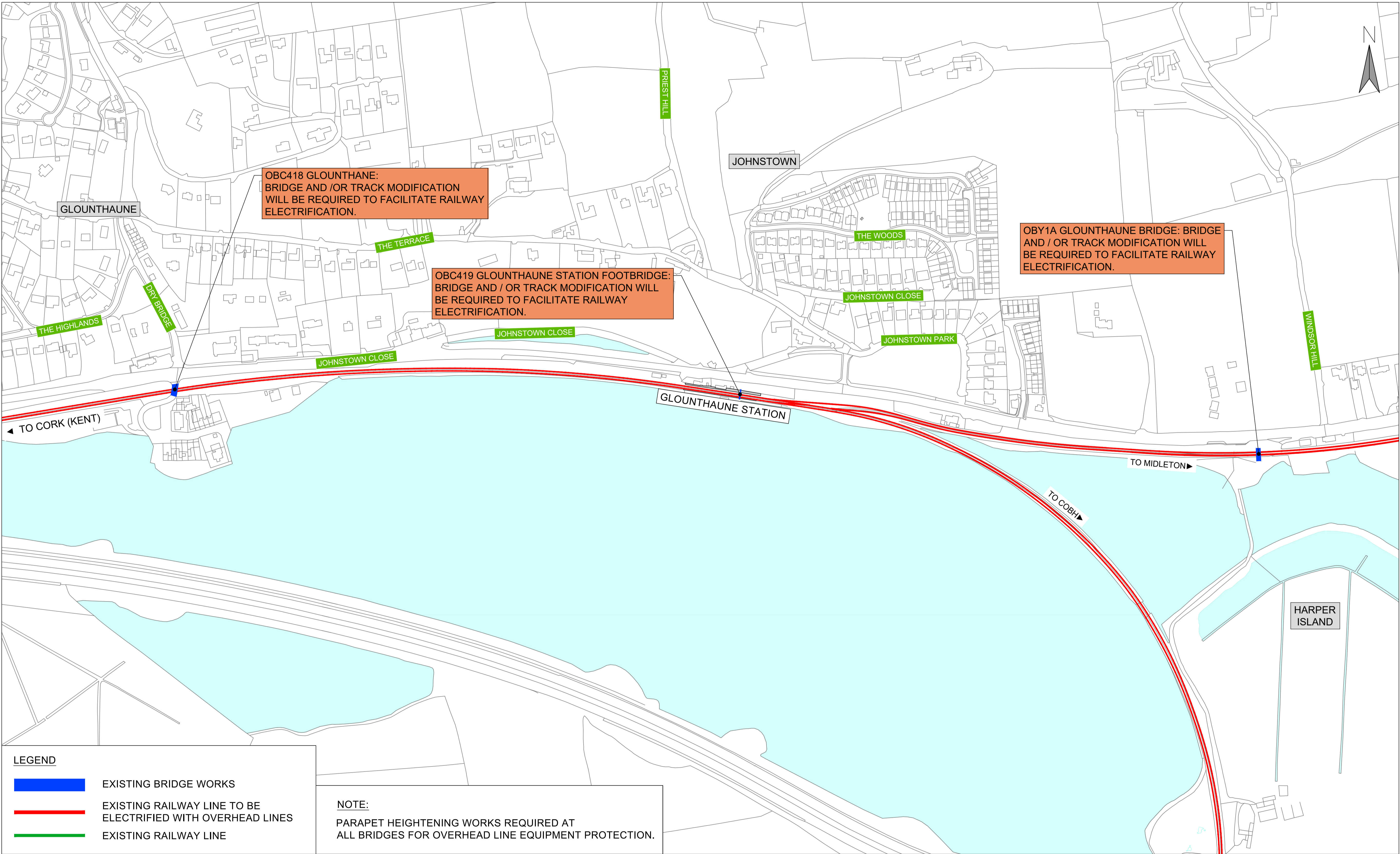

LEGEND

- EXISTING BRIDGE WORKS
- EXISTING RAILWAY LINE TO BE ELECTRIFIED WITH OVERHEAD LINES
- EXISTING RAILWAY LINE

NOTE:
PARAPET HEIGHTENING WORKS REQUIRED AT ALL BRIDGES FOR OVERHEAD LINE EQUIPMENT PROTECTION.

© Irish Rail (2022). This drawing is confidential and the copyright in it is owned by Irish Rail. This drawing must not be either loaned, copied or otherwise reproduced in whole or in part or used for any purpose without the prior permission of Irish Rail.
© Ordnance Survey Ireland and government of Ireland. All O.S. Data used for plans are printed under: "Copyright Ordnance Survey Ireland" Survey No. 0039722. (OSI Aerial Data or OSI Lidar Data) & Survey No. 2022/OSI NMA 180 (OSI Vector Data).
All elevations are in metres and relate to OSI Geoid Model (OSGM02) Malin Head as defined by existing Project Control.
All Co-ordinates are in Irish Transverse Mercator Grid (ITM) as defined by OSI active GPS station Tallaght College (TLLG).



Project Title:
CORK AREA COMMUTER RAIL PROGRAMME
(Main Works)

Figure Number:
FIGURE 006

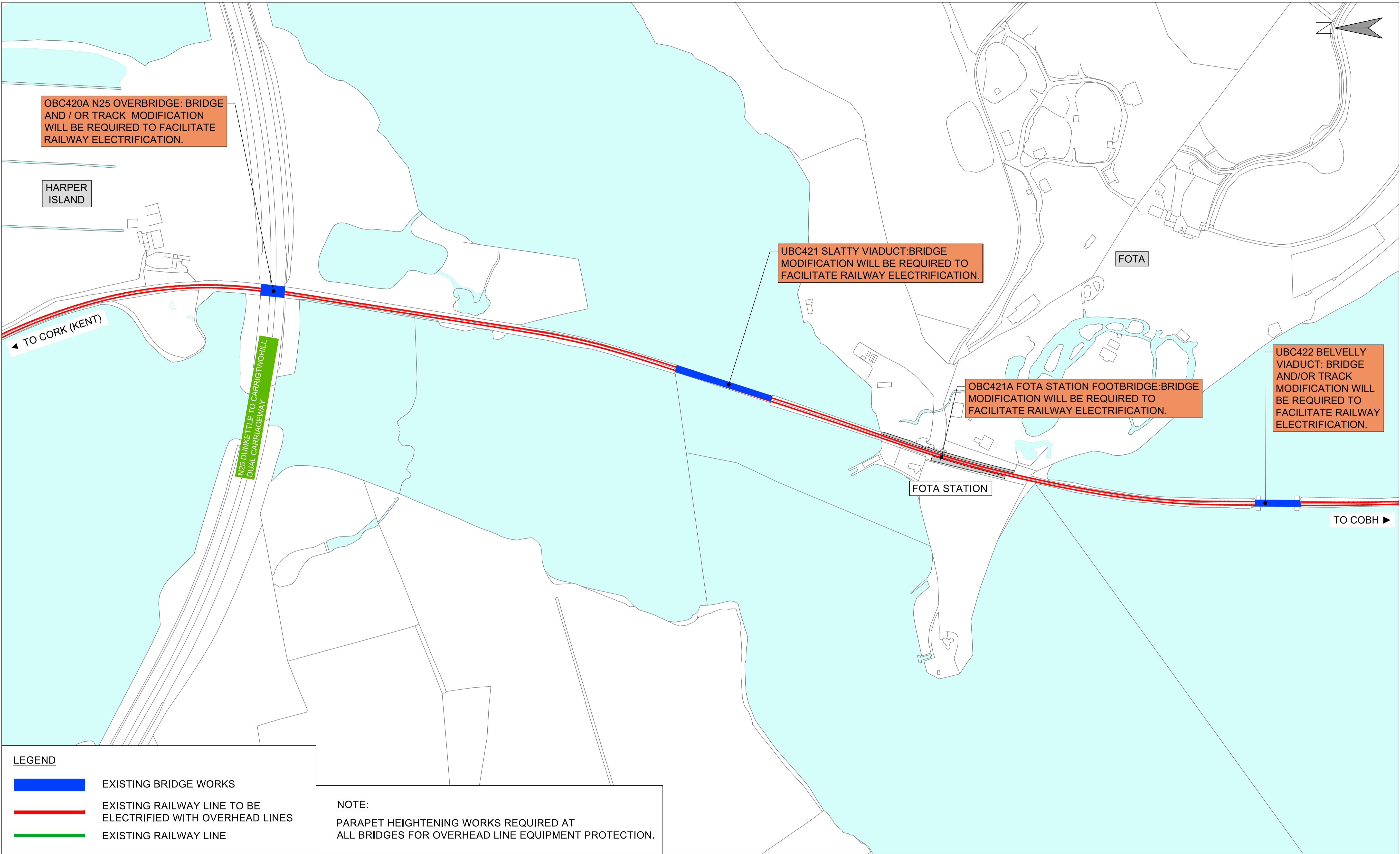

© Irish Rail (2022). This drawing is confidential and the copyright in it is owned by Irish Rail. This drawing must not be either loaned, copied or otherwise reproduced in whole or in part or used for any purpose without the prior permission of Irish Rail.

© Ordnance Survey Ireland and government of Ireland. All O.S. Data used for plans are printed under: "Copyright Ordnance Survey Ireland" Survey No. 0039722. (OSi Aerial Data or OSi Lidar Data) & Survey No. 2022/OSi NMA 180 (OSi Vector Data).

All elevations are in metres and relate to OSi Geoid Model (OSGM02) Malin Head as defined by existing Project Control.

All Co-ordinates are in Irish Transverse Mercator Grid (ITM) as defined by OSi active GPS station Tallaght College (TLLG).

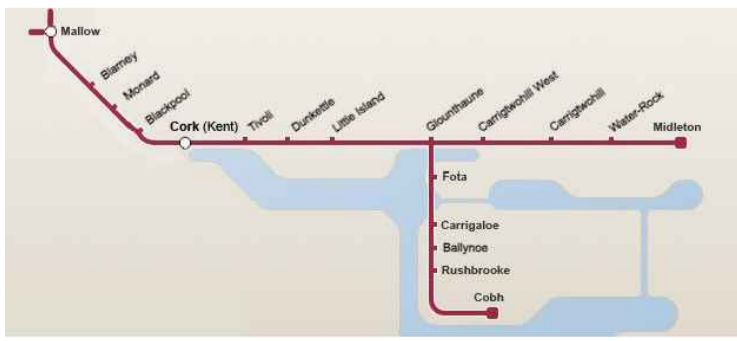

Rialtas
na hÉireann
Government
of Ireland

Tionscadal Éireann
Project Ireland
2040



NTA
Gairíocht Náisiúnta Iomparáil
National Transport Authority



Project Title:
CORK AREA COMMUTER RAIL PROGRAMME
(Main Works)

Figure Number:
FIGURE 007

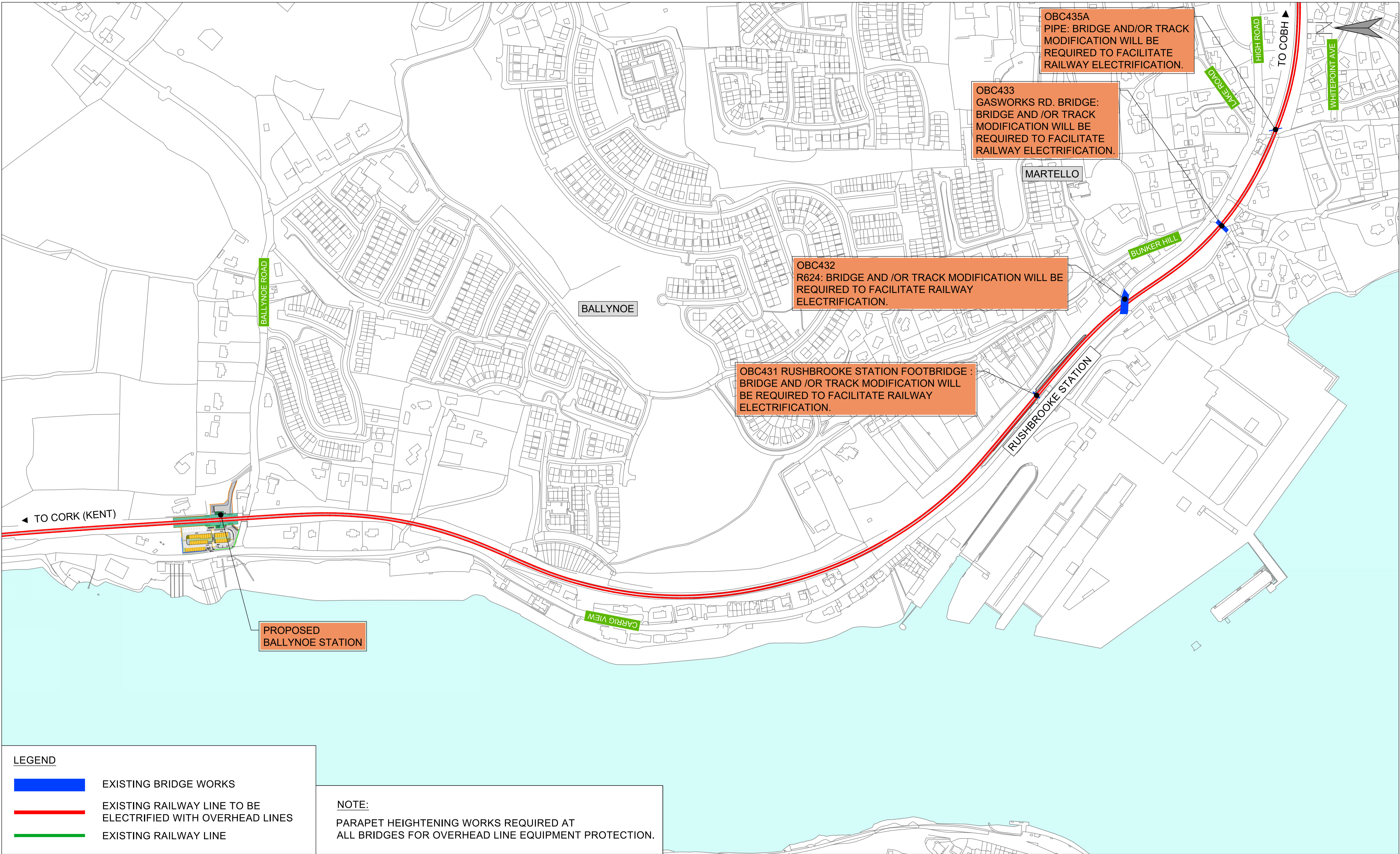

© Irish Rail (2022). This drawing is confidential and the copyright in it is owned by Irish Rail. This drawing must not be either loaned, copied or otherwise reproduced in whole or in part or used for any purpose without the prior permission of Irish Rail.
© Ordnance Survey Ireland and government of Ireland. All O.S. Data used for plans are printed under: "Copyright Ordnance Survey Ireland" Survey No. 0039722. (OSI Aerial Data or OSI Lidar Data) & Survey No. 2022/OSI_NMA_180 (OSI Vector Data).
All elevations are in metres and relate to OSI Geoid Model (OSGM02) Malin Head as defined by existing Project Control.
All Co-ordinates are in Irish Transverse Mercator Grid (ITM) as defined by OSI active GPS station Tallaght College (TLLG).

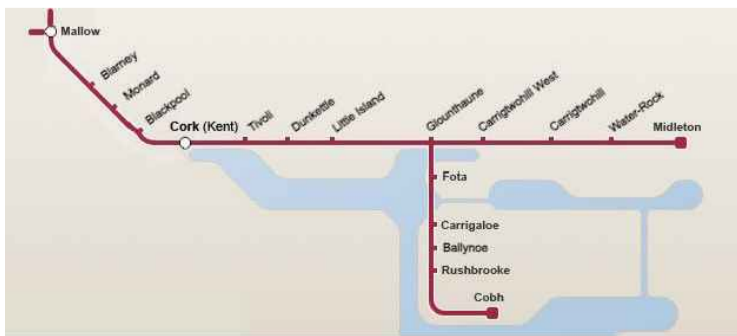

Rialtas na hÉireann
Government of Ireland
Tionscadal Éireann
Project Ireland
2040



Project Title:
CORK AREA COMMUTER RAIL PROGRAMME
(Main Works)

Figure Number:
FIGURE 010

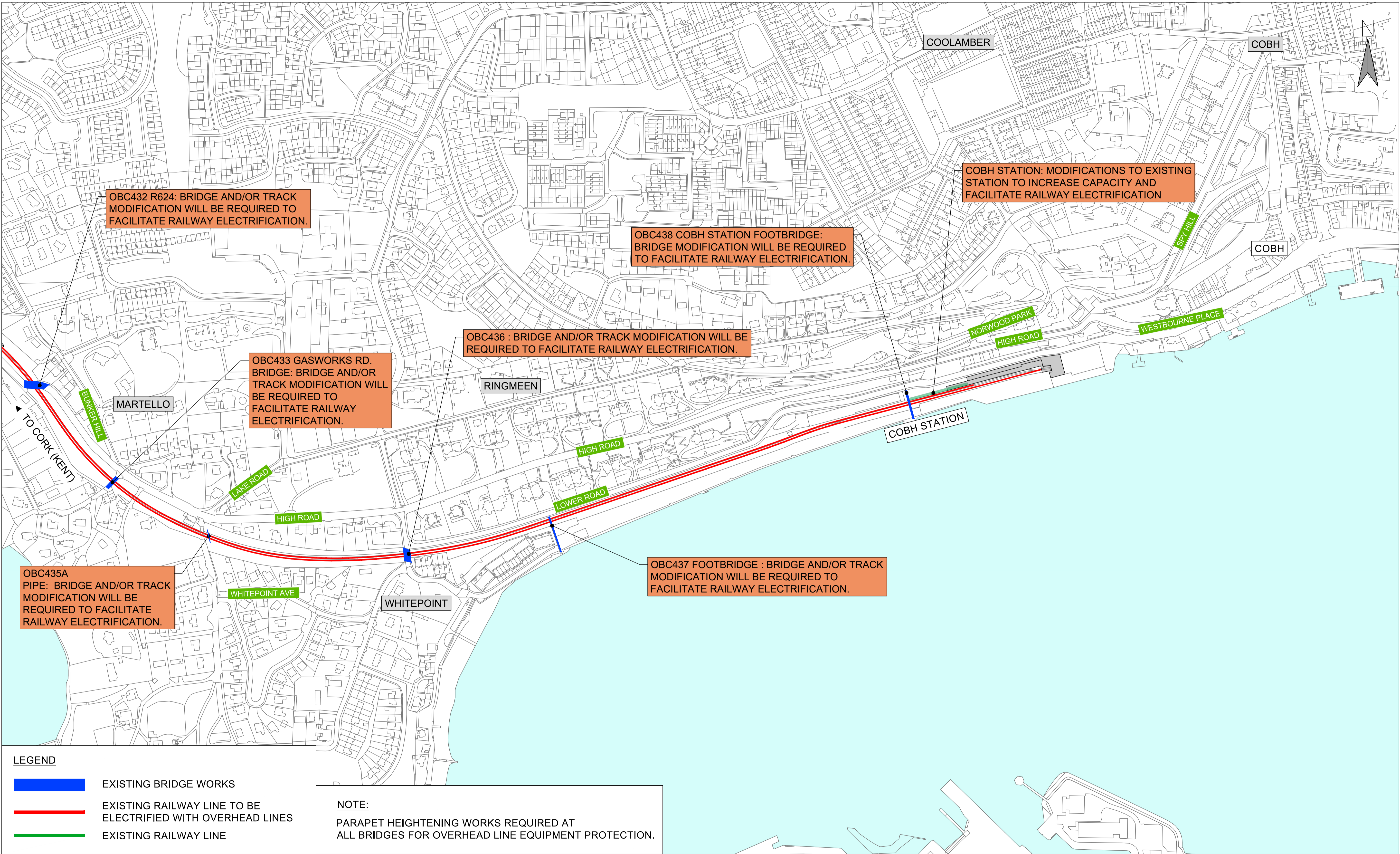

© Irish Rail (2022). This drawing is confidential and the copyright in it is owned by Irish Rail. This drawing must not be either loaned, copied or otherwise reproduced in whole or in part or used for any purpose without the prior permission of Irish Rail.
© Ordnance Survey Ireland and government of Ireland. All O.S. Data used for plans are printed under: "Copyright Ordnance Survey Ireland" Survey No. 0039722 (OSI Aerial Data or OSI Lidar Data) & Survey No. 2022/OSI_NMA_180 (OSI Vector Data).
All elevations are in metres and relate to OSI Geoid Model (OSGM02) Malin Head as defined by existing Project Control.
All Co-ordinates are in Irish Transverse Mercator Grid (ITM) as defined by OSI active GPS station Tallaght College (TLLG).



Project Title: CORK AREA COMMUTER RAIL PROGRAMME (Main Works)

Figure Number: FIGURE 011