

24th October 2017

[REDACTED]

[REDACTED]

[REDACTED]

[REDACTED]

[REDACTED]

[REDACTED]

Re: FOI Request Response [IE_FOI_114]

Dear [REDACTED],

I refer to your request dated 06th September 2017 made under the Freedom of Information Act 2014, which was received on 06th September 2017 for records held by Iarnród Éireann. Your request sought:

Request –

- (a) The Location
- (b) The extent of the lands purchased

In the vicinity of Ashtown Road, Mill Lane, Martin Savage Park and/or Palletstown by Irish Rail in the last five years as reported in the midtown review of the Ashtown/Palletstown area plan (Including relevant maps)

I, [REDACTED] Freedom of Information / Data Protection Officer have now made a final decision to release this record on the 06th October 2017.

Rights of appeal

In the event that you are not happy with this decision you can make an appeal in relation to this matter, you can do so by writing to the FOI Unit, Corporate Communications, Iarnród Éireann Irish Rail, Connolly Station, Amiens St, Dublin 1 or by e-mail to foi@irishrail.ie. You should make your appeal within 4 weeks (20 working days) from the date of this notification, where a day is defined as a working day excluding, the weekend and public holidays, however, the making of a late appeal may be permitted in appropriate circumstances. The appeal will involve a complete reconsideration of the matter by a more senior member of the staff of this body.

Should you have any questions or concerns regarding the above, please contact the FOI Officer on 01, 7034293.

Yours sincerely,

[REDACTED]

Freedom of Information / Data Protection Officer

Freedom of Information Request:
Schedule of Records for [IE_FOI_114](#) : Summary for Decision Making

| Record No. | Date of Record | Brief Description | No. of Pages | Decision: Grant/Part Grant/Refuse | Section of Act if applicable | Record Edited/Identify Deletions |
|------------|----------------|------------------------------|--------------|-----------------------------------|------------------------------|----------------------------------|
| 1 | 07.06.17 | IE_FOI_114 Response Document | 1 | Grant | | |

Signed



IE Decision Maker

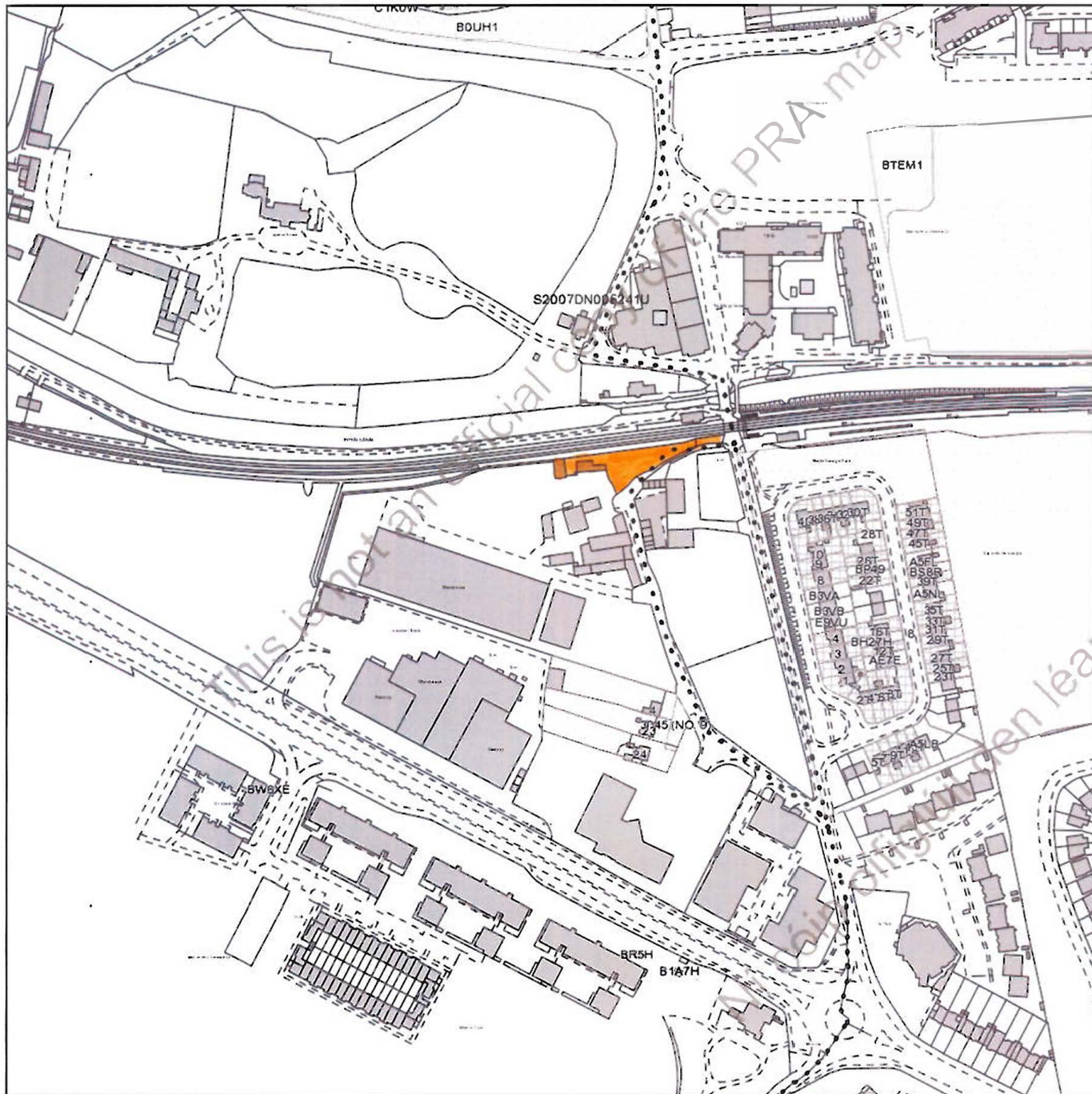

**The Property
Registration Authority
An tÚdarás
Clárúcháin Maoinne**



Print map images taken from www.landdirect.ie may be used for information purposes only.

Ni fhéadtar na hiomhánna léarscáile priontáilte arna fháil ó www.landdirect.ie a úsáid ach chun críocha eolais amháin.

This map incorporates Ordnance Survey Ireland (OSi) mapping data under a licence from OSi. Copyright © OSi and Government of Ireland.

Corpraíonn an mapa seo sonraí mapála Shuirbhéireacht Ordánais na hÉireann (OSi) faoi cheadúnas ón OSi. Cóipcheart © OSi agus Rialtas na hÉireann

The registry operates a non-conclusive boundary system.

The Registry Map identifies properties not boundaries meaning neither the description of land in a register nor its identification by reference to a registry map is conclusive as to the boundaries or extent. (See Section 85 of the Registration of Title Act, 1964). As inserted by Section 62 of the Registration of Deed and Title Act 2006.

Feidhmíonn Clárallann na Tairín córas teorann neamh-dhochloite. Aithníonn Mapa na Clárlainne maoinne nach ionann agus teorainneacha, rud a chiallaíonn nach bhfuil an cur síos ar thalamh i gclár ná a hálthint trí thagairt do mhapa clárlainne cinntitheach maidir le teorainneacha ná fairsinge. (Féach Ailt 85 den Acht um Chláru Teidil, 1964). Mar a ionadaíodh ag Ailt 62 den Acht um Chláru Gníomhas agus Teidil 2006.

